

Salon Maria Callas

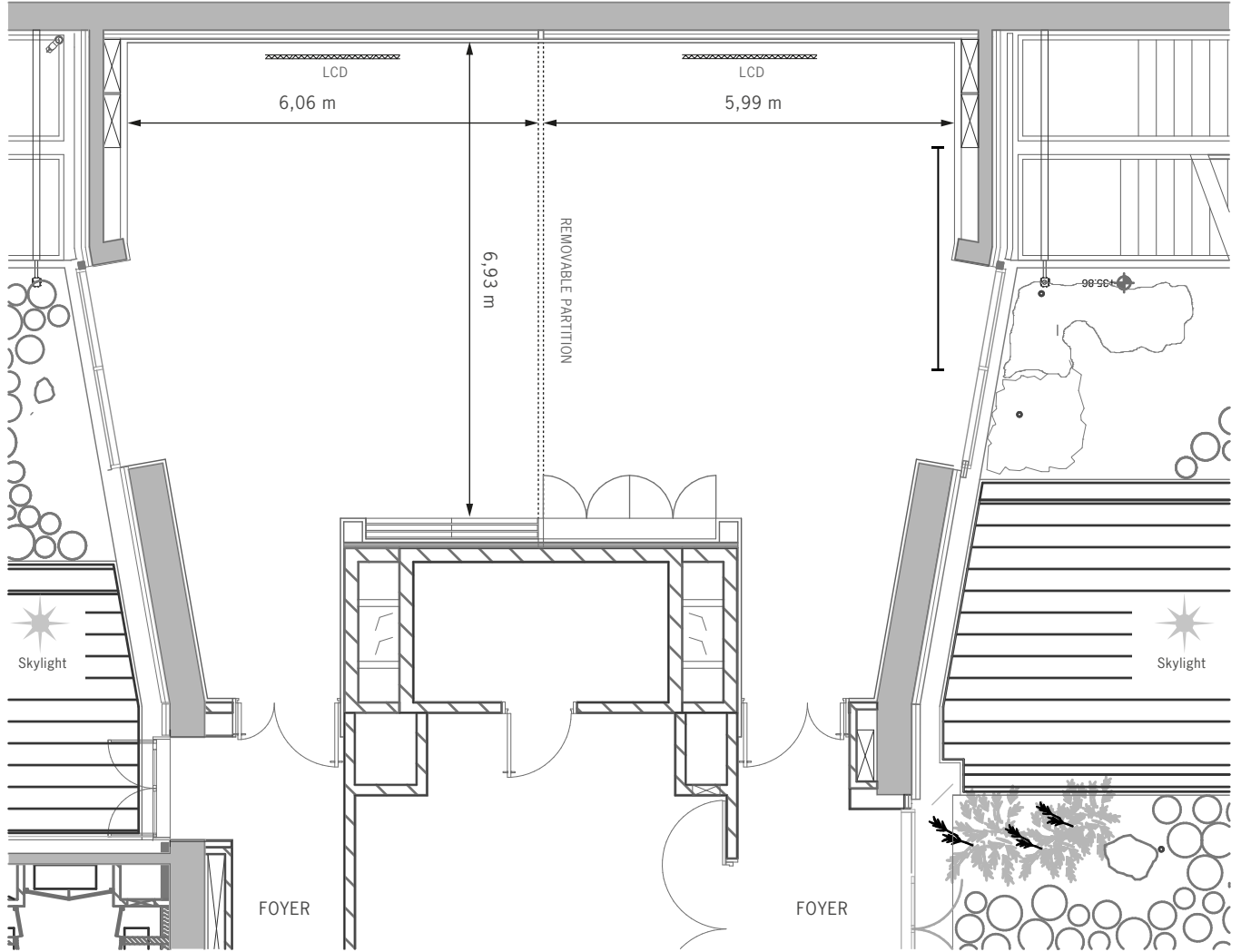

Legend

Scale: 1/200

Level : - 3
Height to ceiling: 3,05 m / 10.01 ft

Salon Maria Callas area: 96 sq m / 1,033 sq ft
Salon Maria Callas 1 area: 48 sq m / 517 sq ft
Salon Maria Callas 2 area: 48 sq m / 517 sq ft

- retractable screen
- ▨ LCD screen
- ⋯ removable partition
- ☀ daylight



	Board	Cabaret	Classroom	Theatre	U-shape	Hollow Square	Banquet	Cocktail
SALON MARIA CALLAS	30	42	36	80	33	-	60	80
SALON MARIA CALLAS 1	18	-	18	44	18	-	-	40
SALON MARIA CALLAS 2	18	-	18	44	18	-	-	40

Scale : 1/200

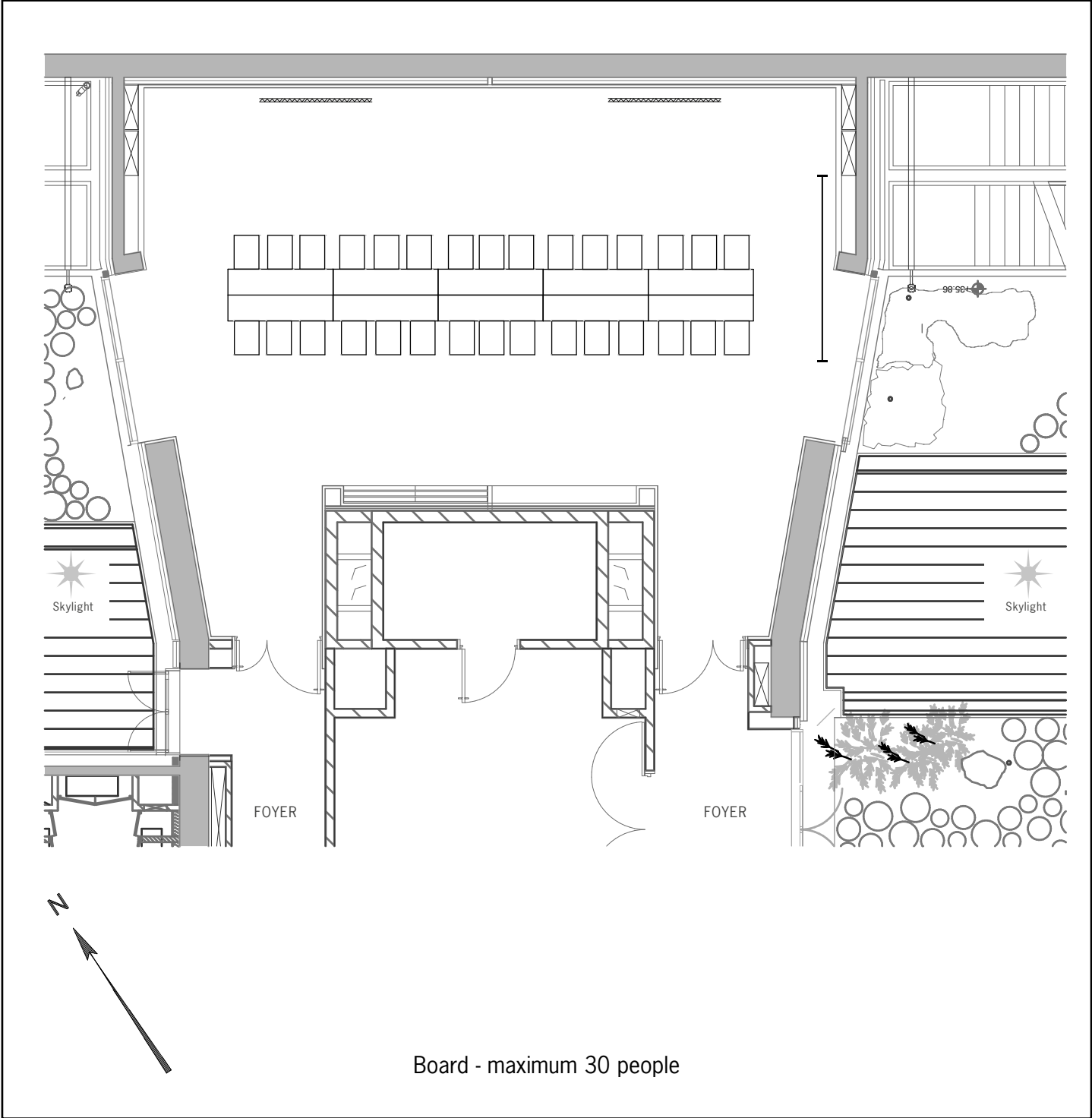

For technical information, please refer to general floorplan (without set-up)

Scale : 1/200

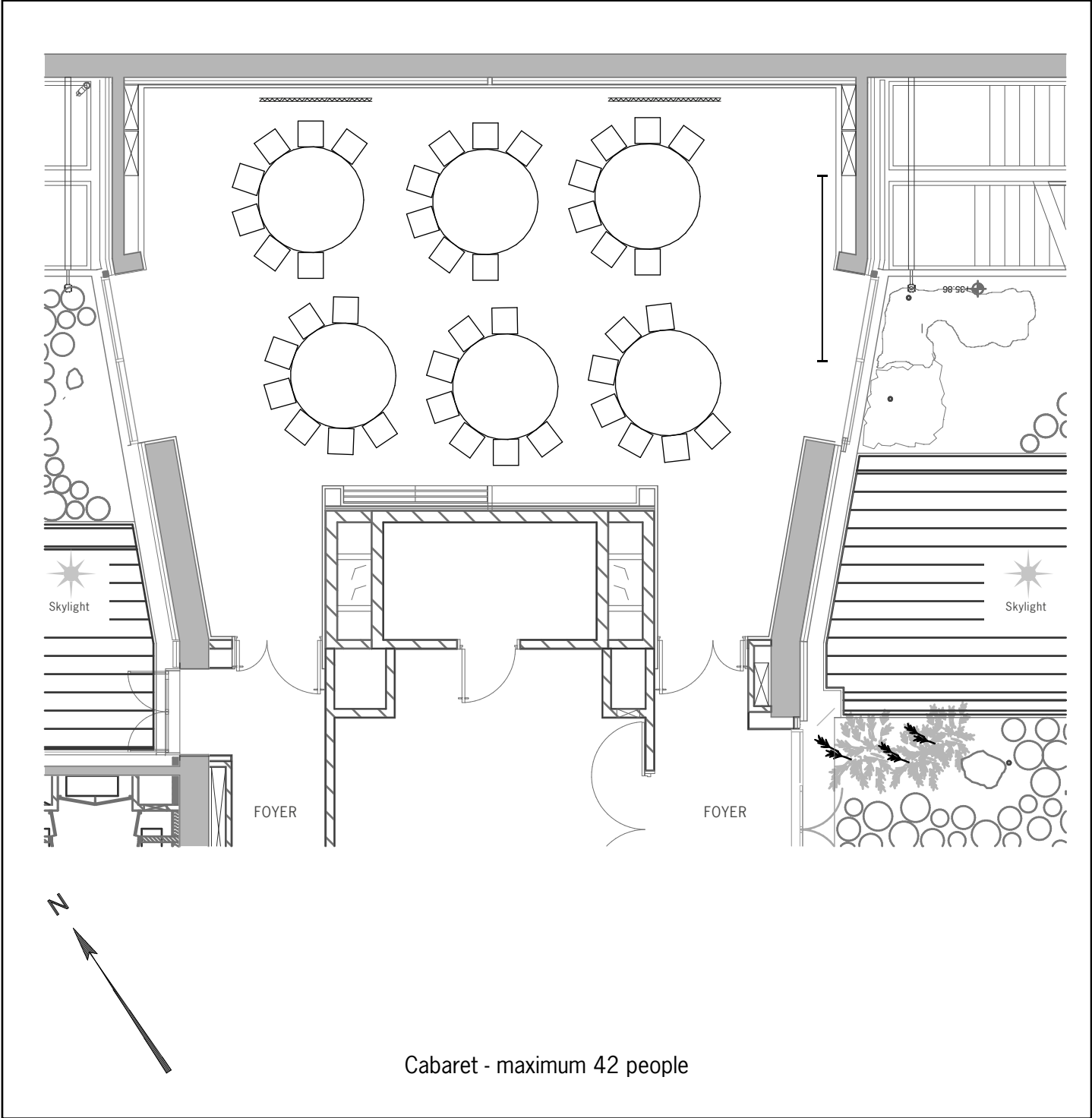

For technical information, please refer to general floorplan (without set-up)

Scale : 1/200

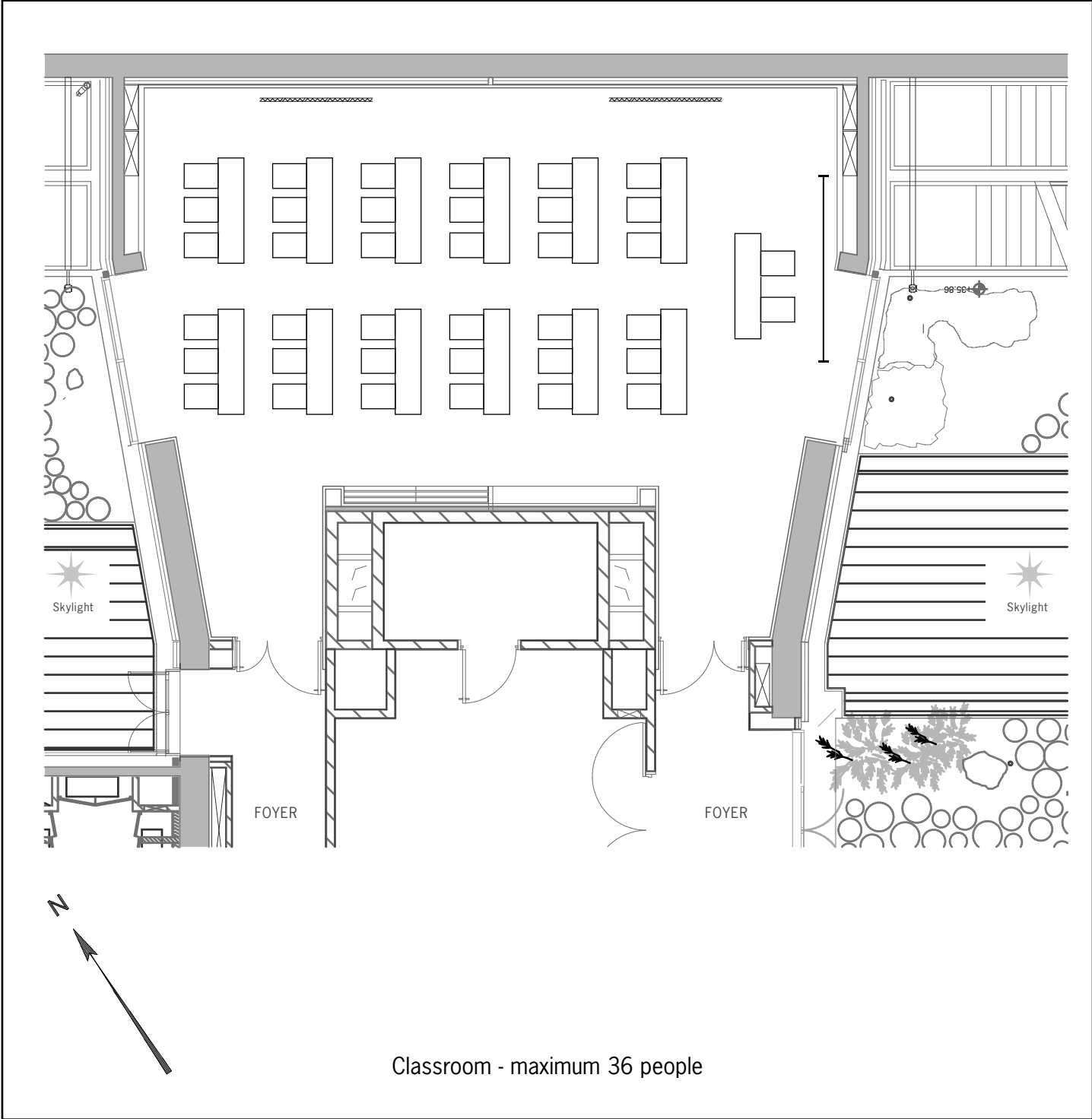

For technical information, please refer to general floorplan (without set-up)

Scale : 1/200

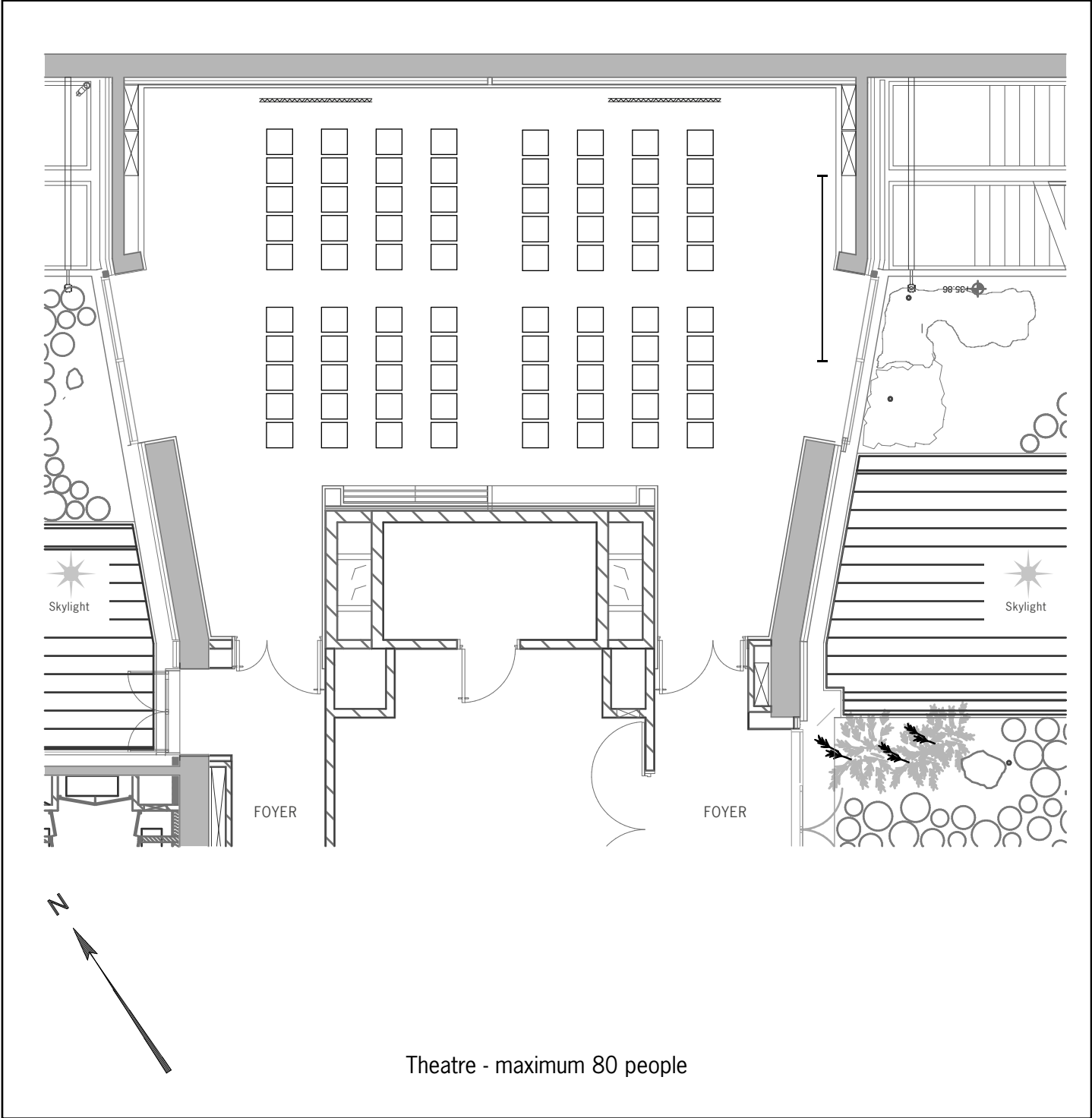

For technical information, please refer to general floorplan (without set-up)

Salon Maria Callas

Scale : 1/200

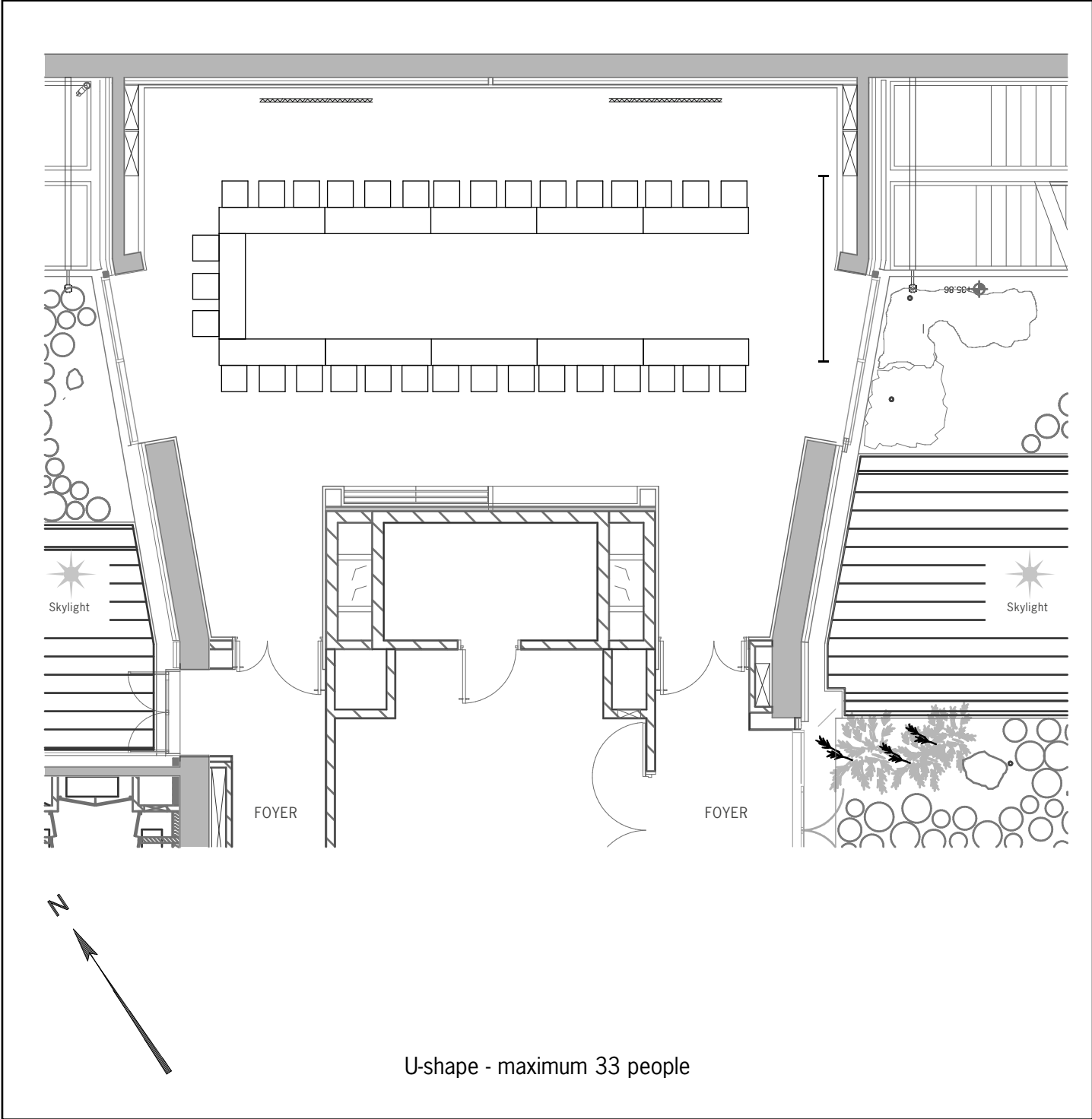

For technical information, please refer to general floorplan (without set-up)

Scale : 1/200

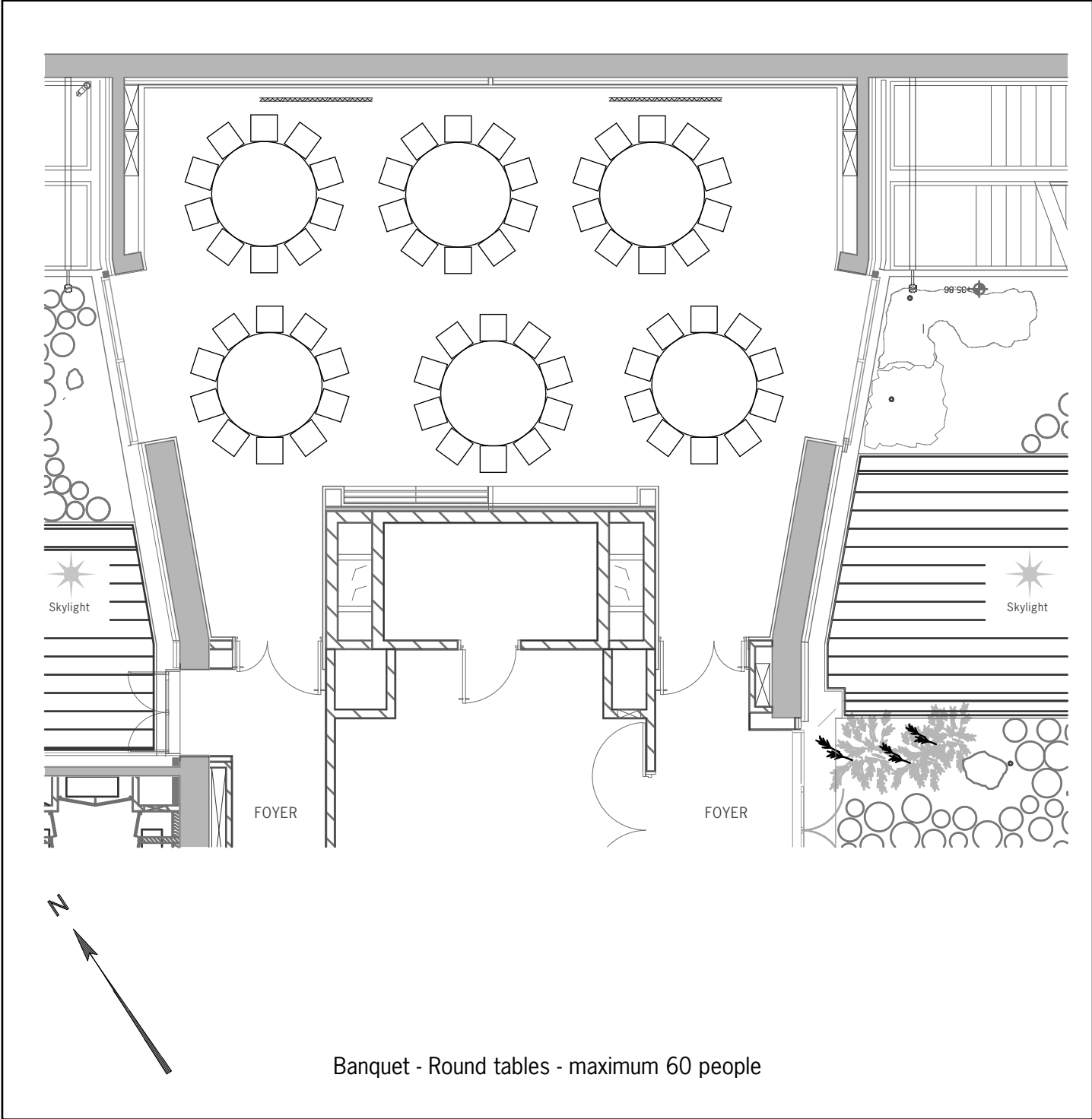

For technical information, please refer to general floorplan (without set-up)

Scale : 1/200

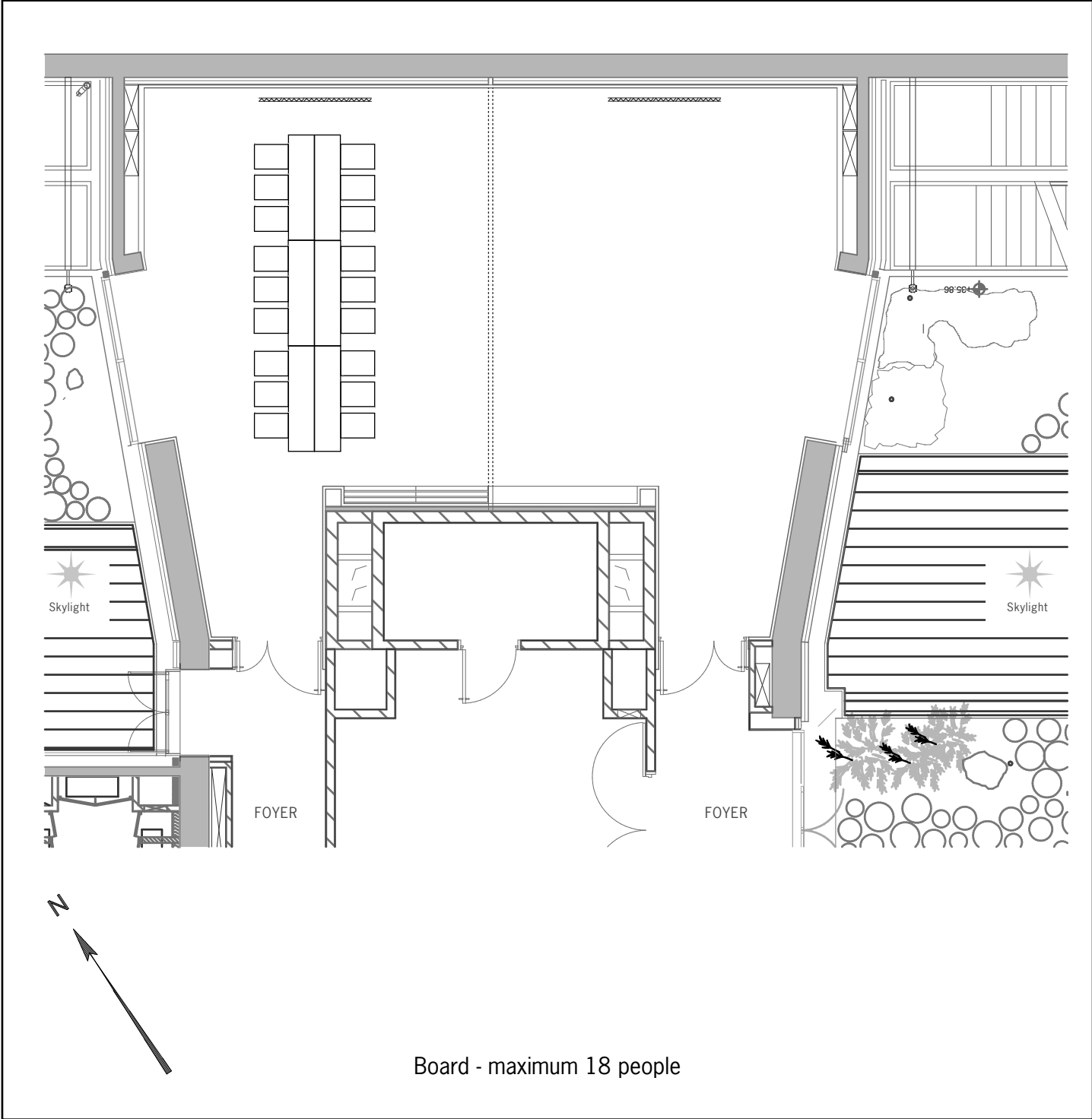

For technical information, please refer to general floorplan (without set-up)

Scale : 1/200

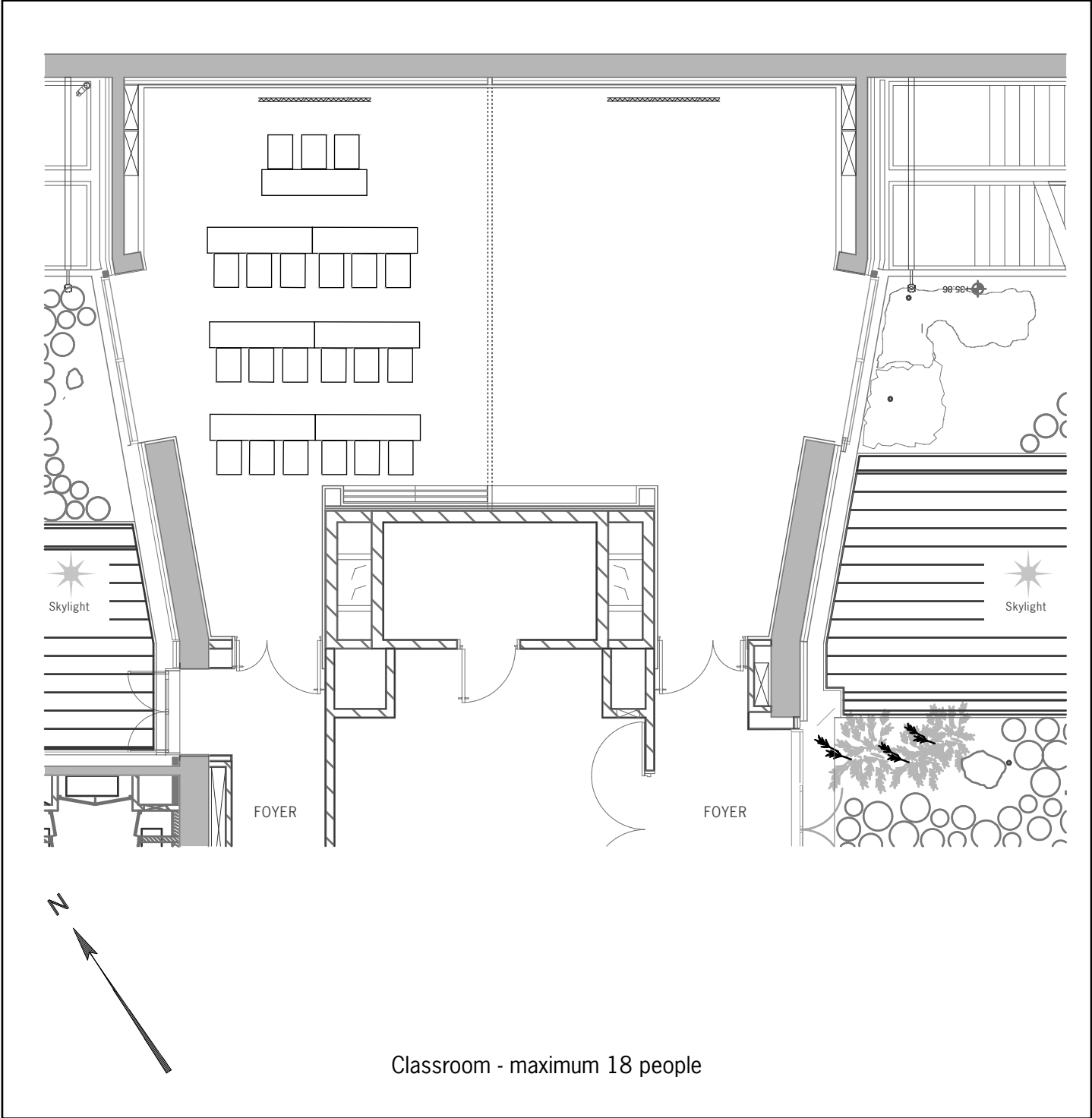

Classroom - maximum 18 people

For technical information, please refer to general floorplan (without set-up)

Scale : 1/200

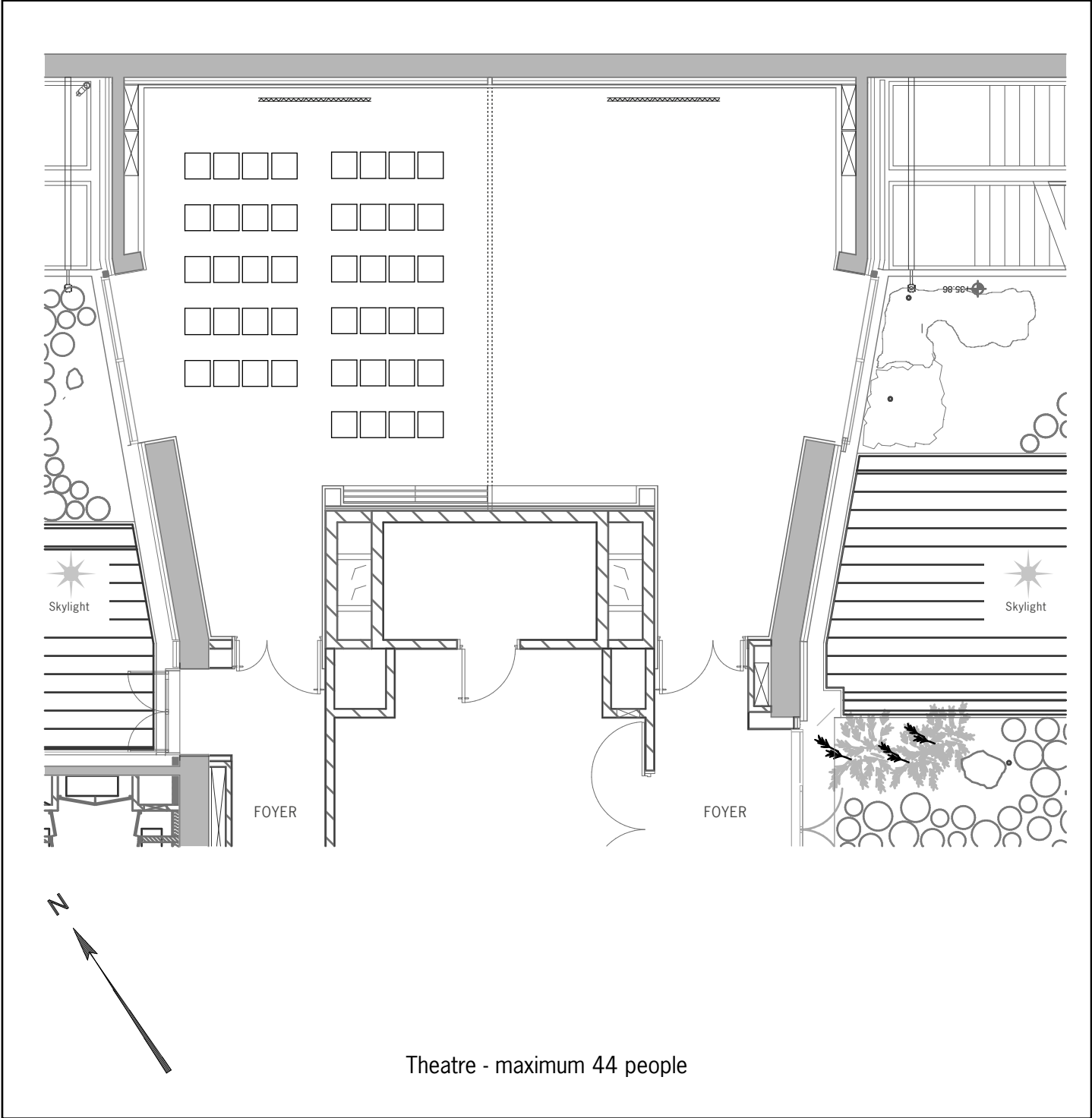

For technical information, please refer to general floorplan (without set-up)

Scale : 1/200

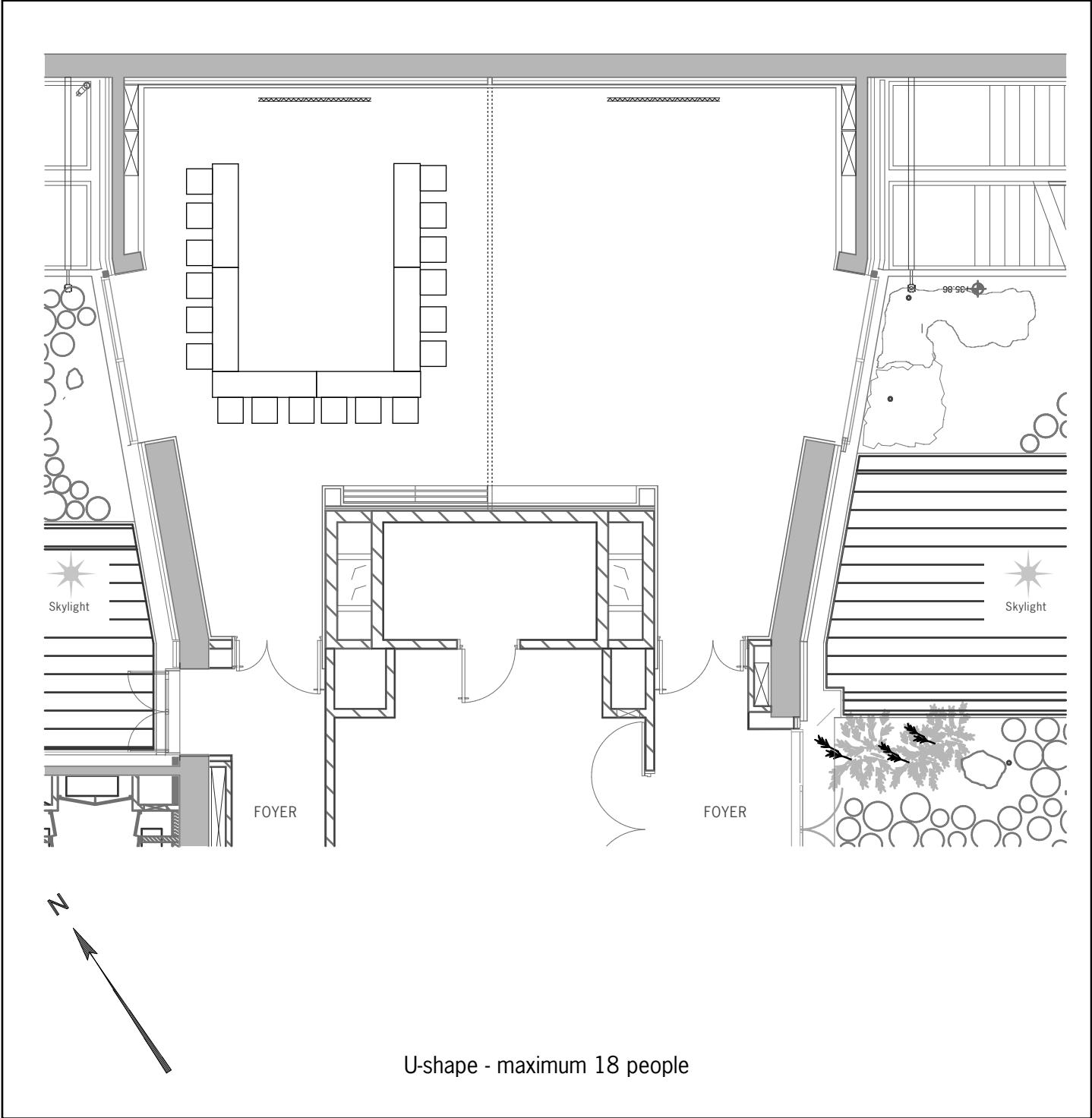

For technical information, please refer to general floorplan (without set-up)

Scale : 1/200

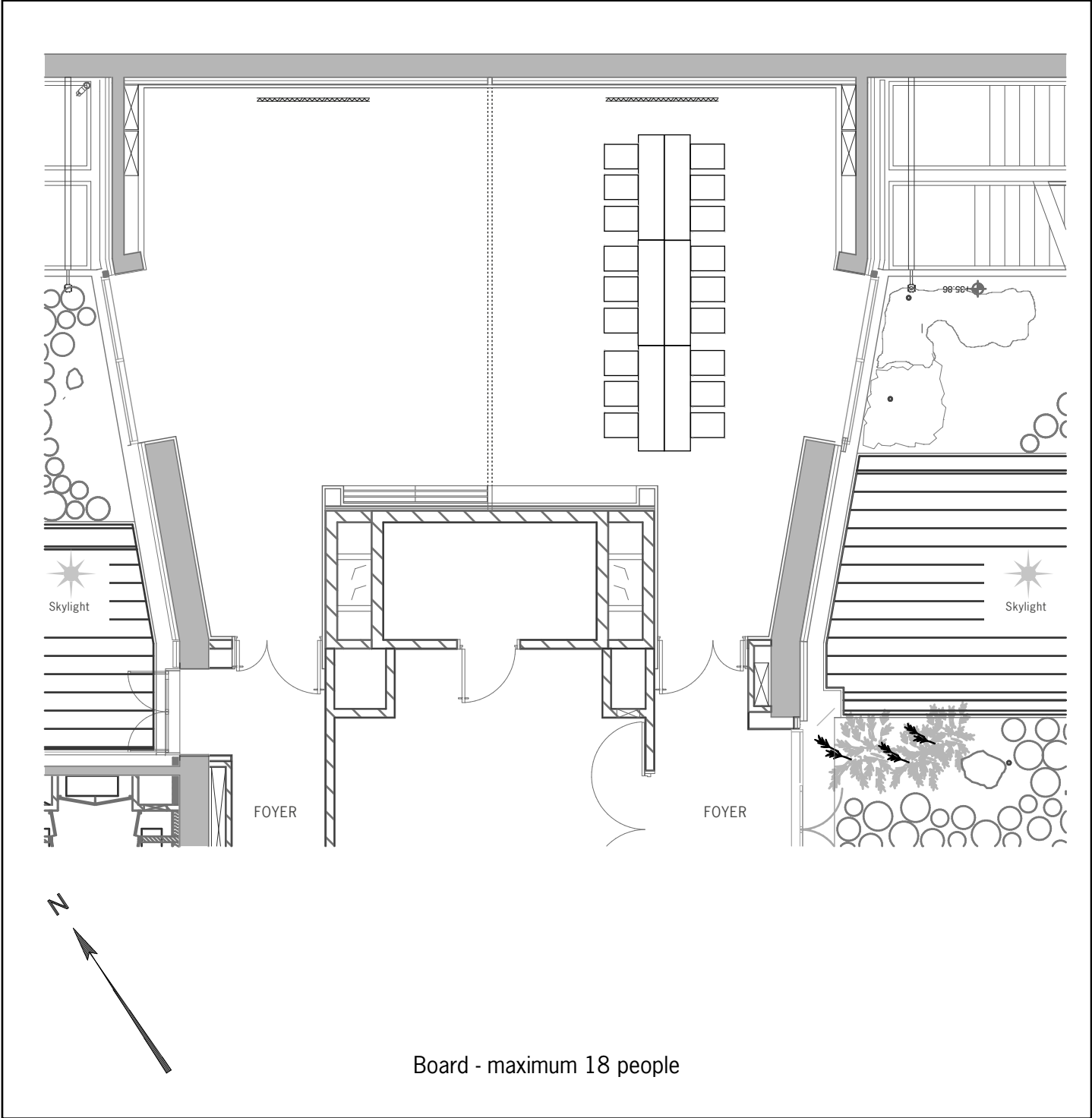

For technical information, please refer to general floorplan (without set-up)

Scale : 1/200

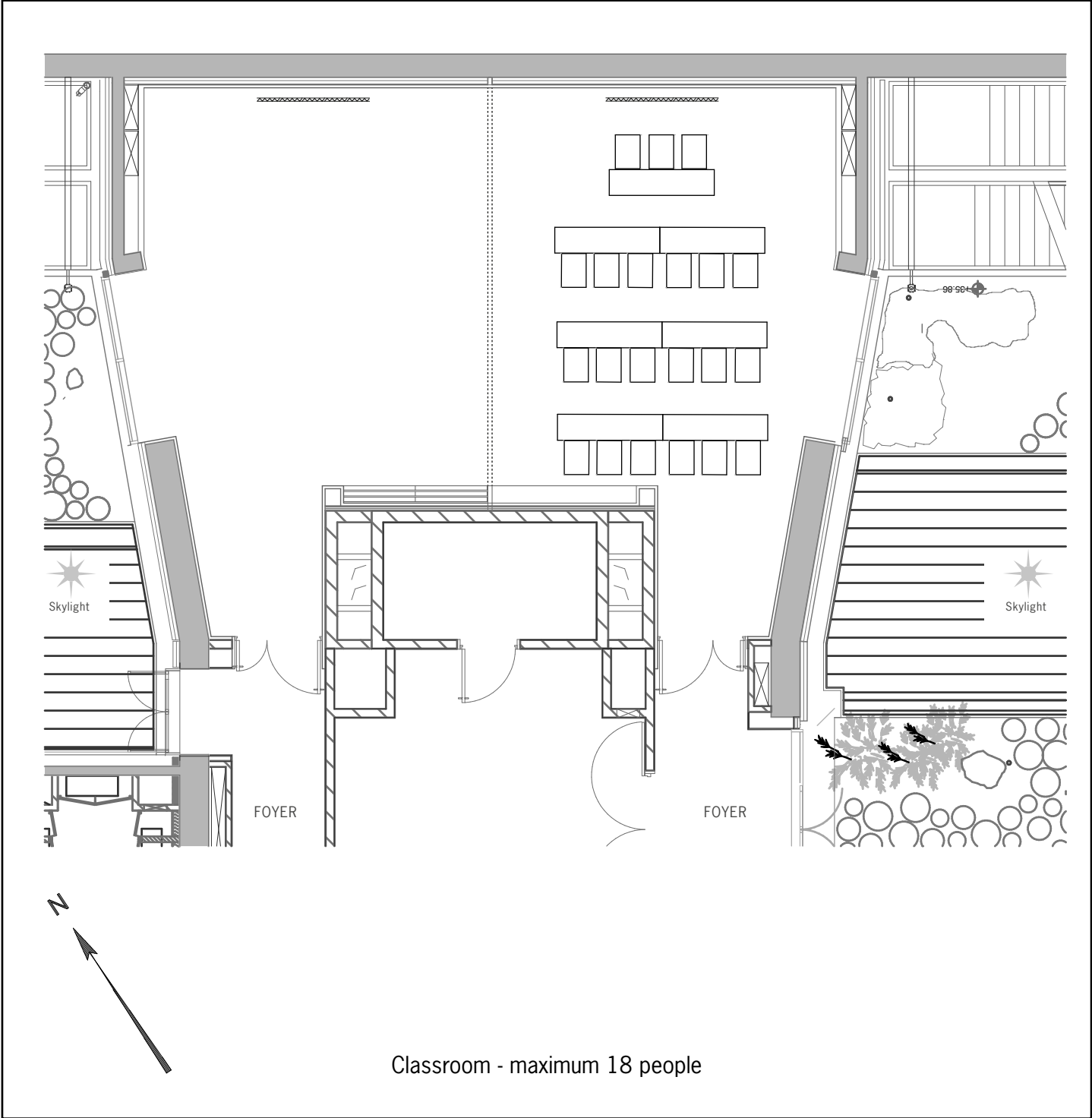

For technical information, please refer to general floorplan (without set-up)

Scale : 1/200

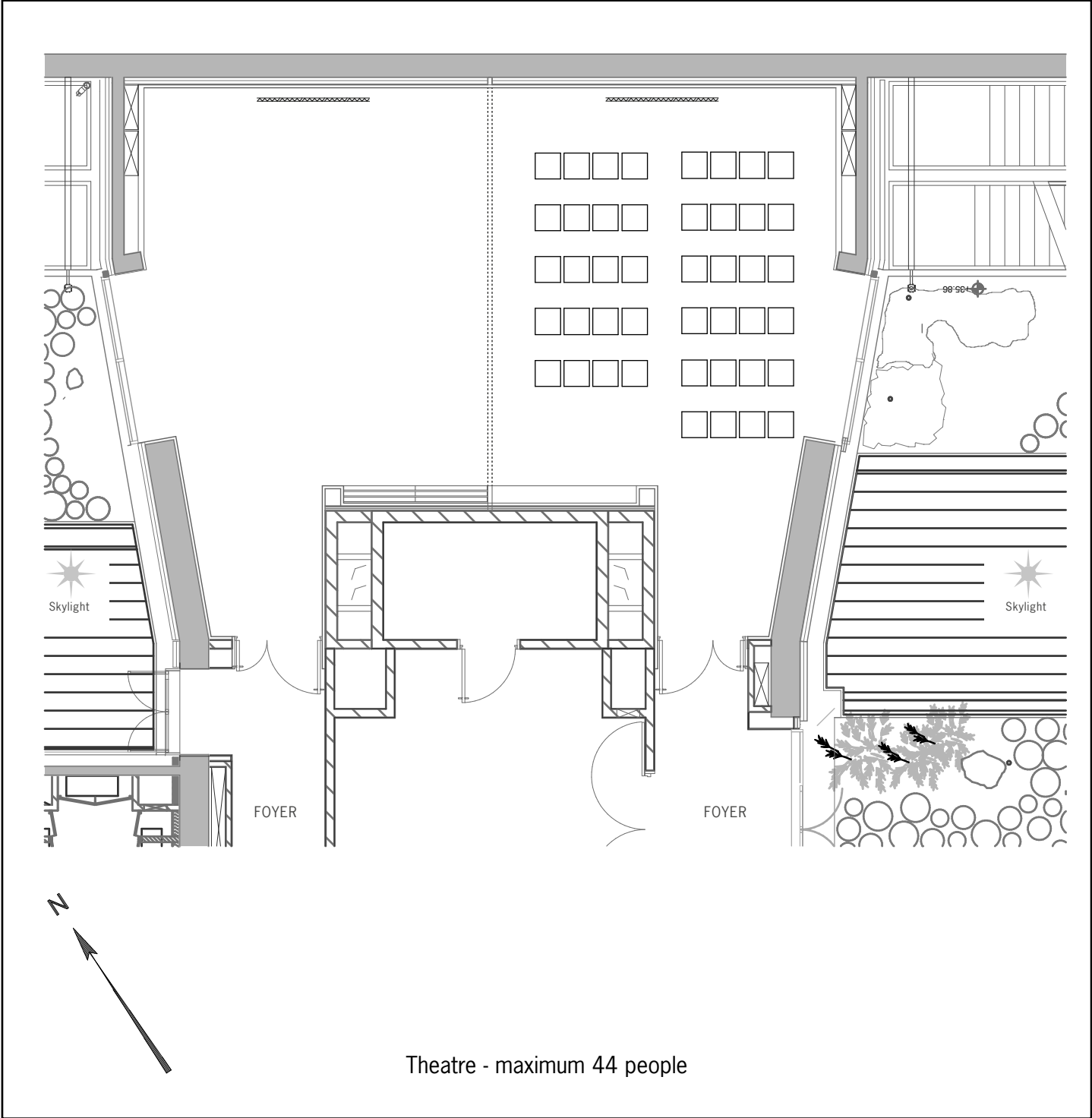

For technical information, please refer to general floorplan (without set-up)

Scale : 1/200

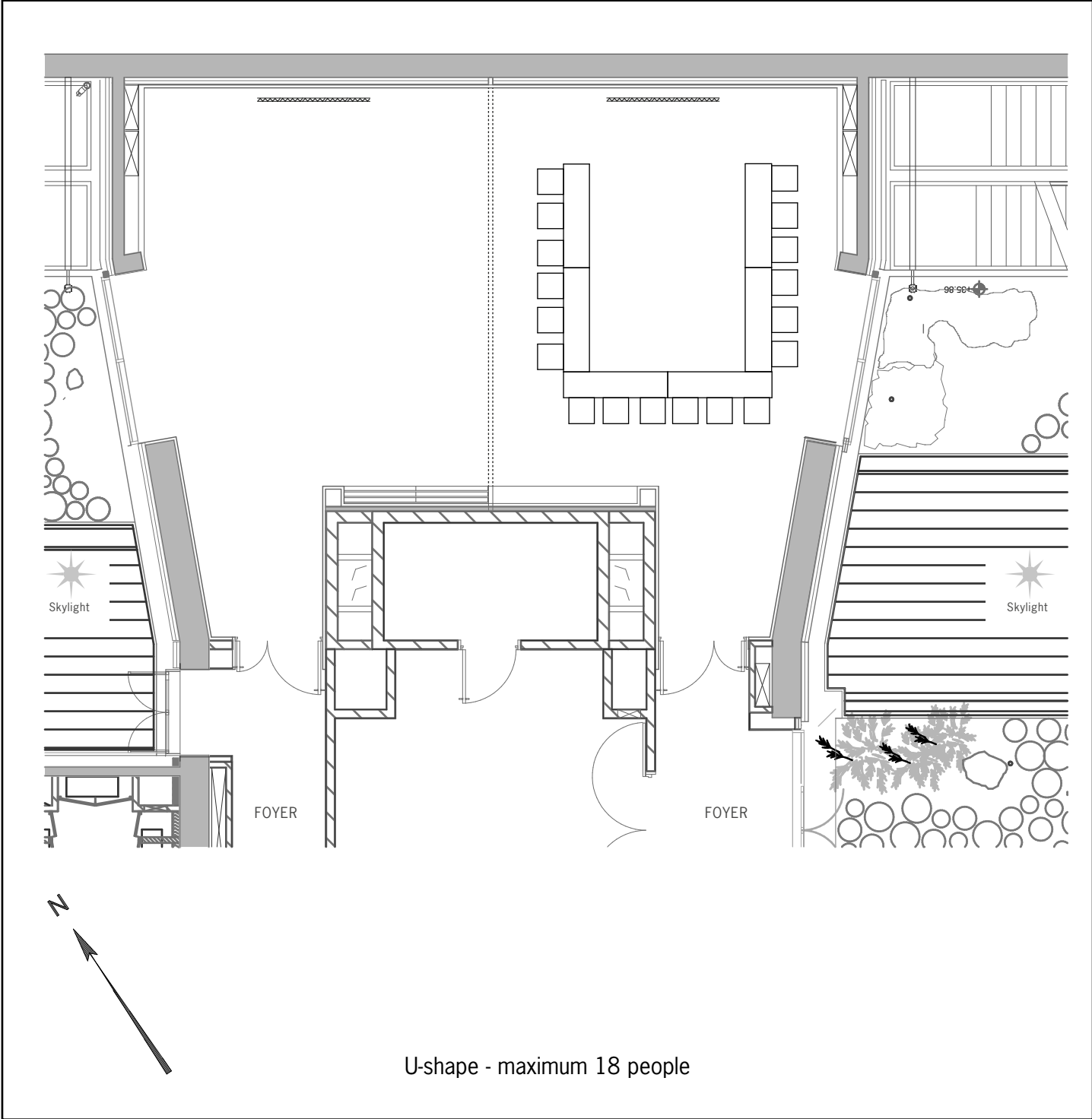

For technical information, please refer to general floorplan (without set-up)