

Salle Jean Cocteau

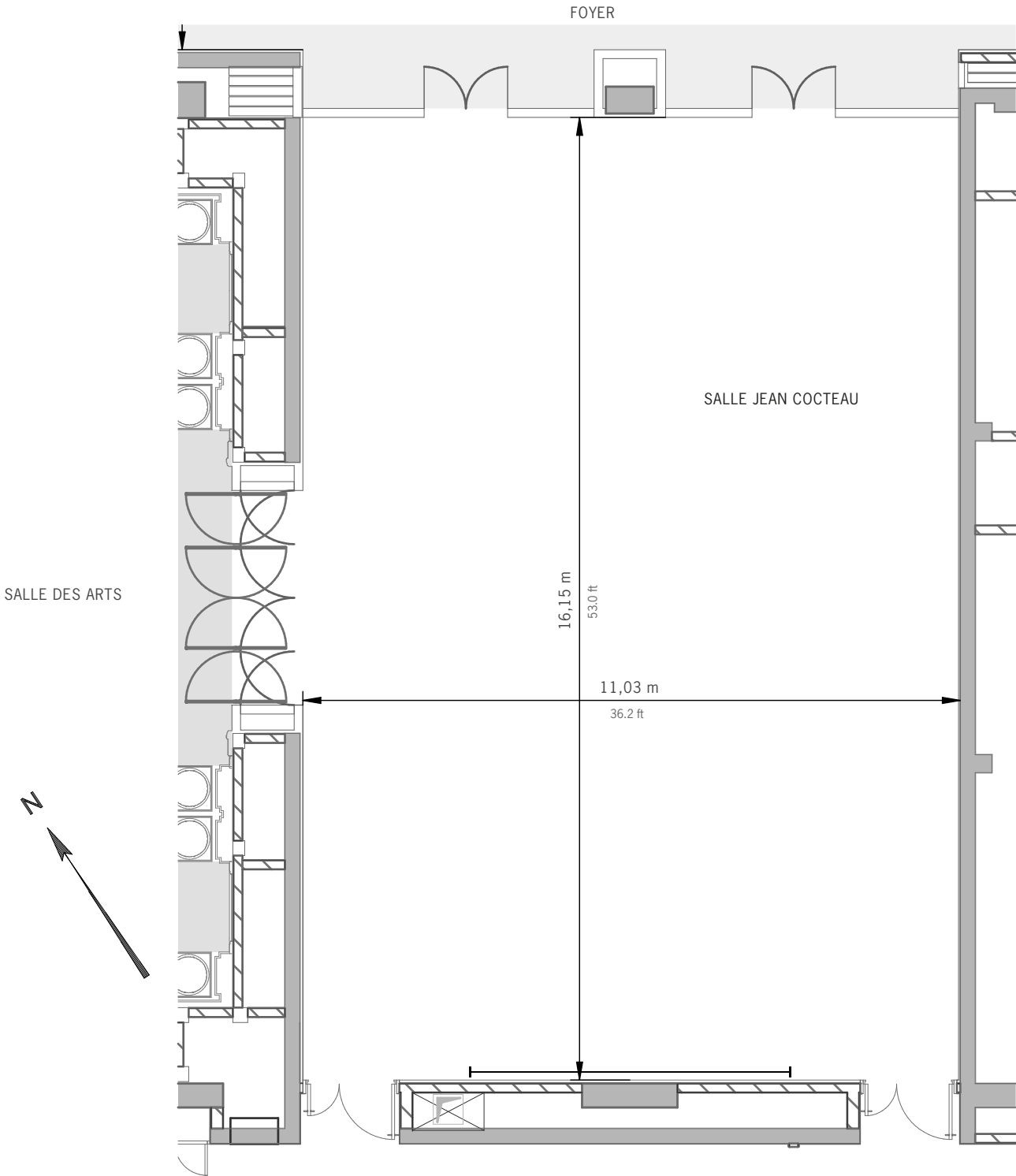

Legend
 Level : - 3
 Height to ceiling: 5,65 m / 18.54 ft
 Total area: 177,65 sq m / 1,912 sq ft
 Scale: 1/100
 — retractable screen



	Board	Cabaret	Classroom	Theatre	U-shape	Hollow Square	Banquet	Cocktail
SALLE JEAN COCTEAU	o.r.	105	108	198	51	-	168	180

Scale : 1/100

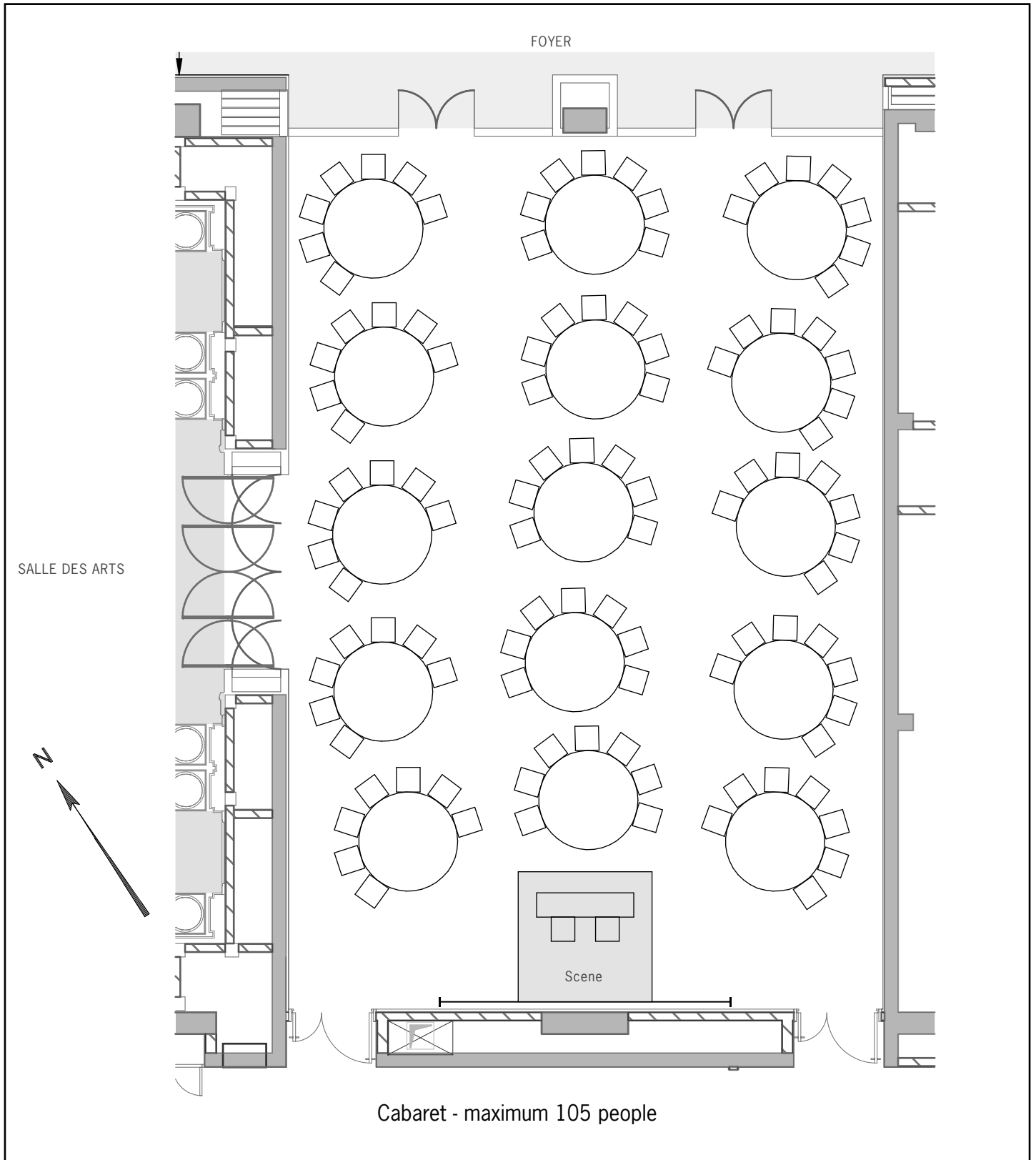

Scale : 1/100

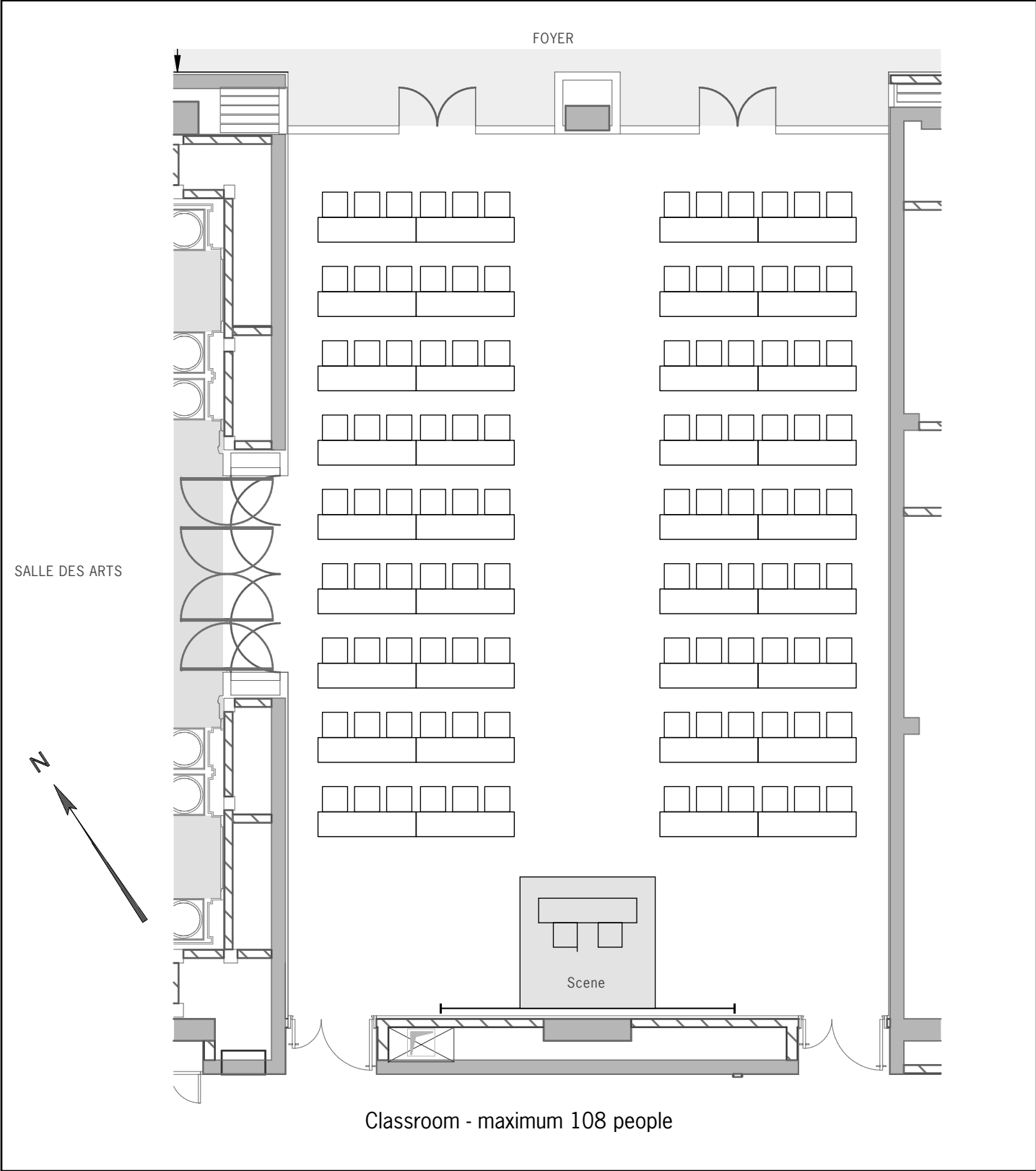

ONE MC S.C.3.GB-09-19 NON CONTRACTUAL

For technical information, please refer to general floorplan (without set-up)

Scale : 1/100

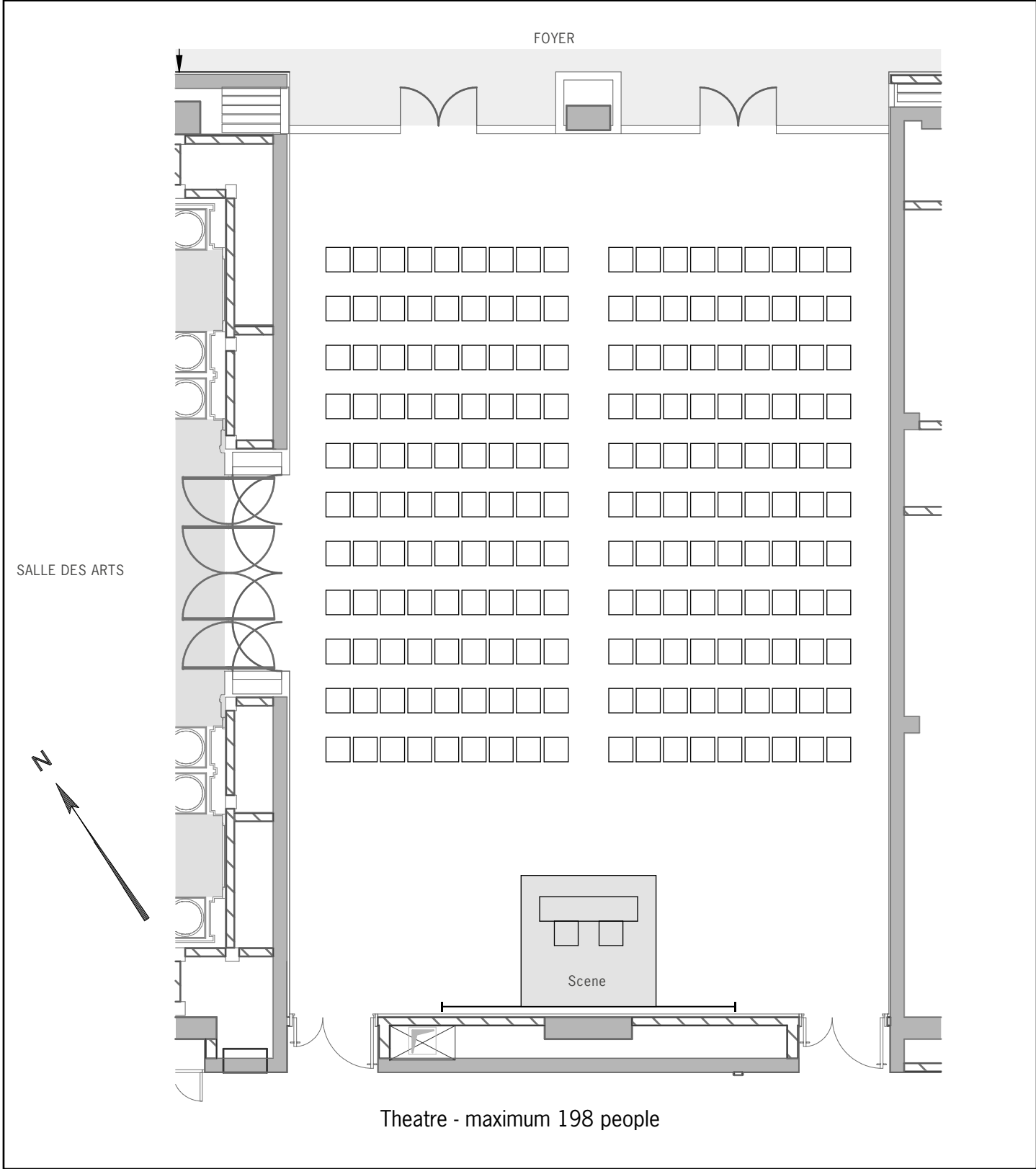

ONE MC S.JC.4GB-06-22 NON CONTRACTUAL

For technical information, please refer to general floorplan (without set-up)

Scale : 1/100

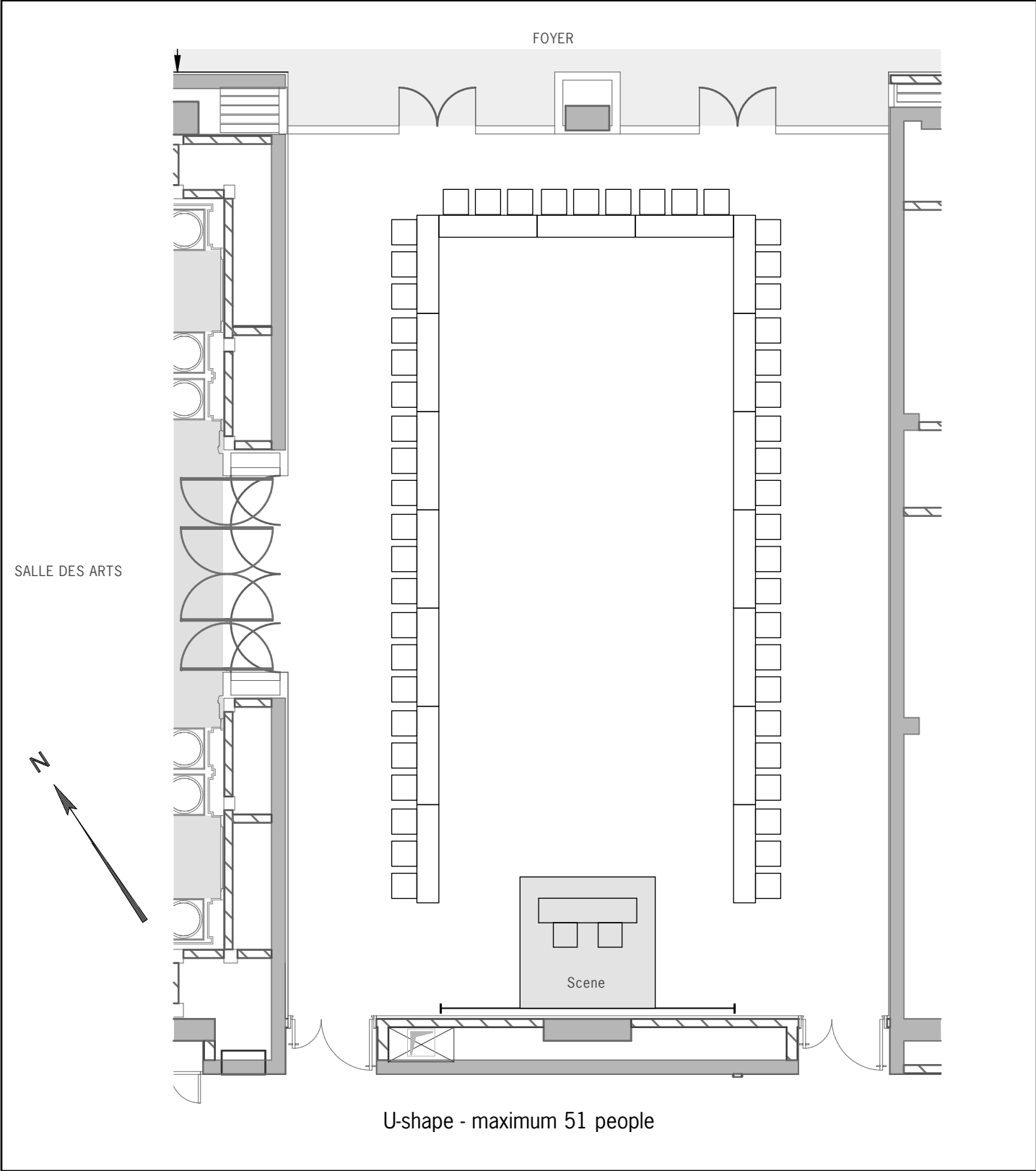

ONE MC S.J.C.5.GB-09-19 NON CONTRACTUAL

For technical information, please refer to general floorplan (without set-up)

Scale : 1/100

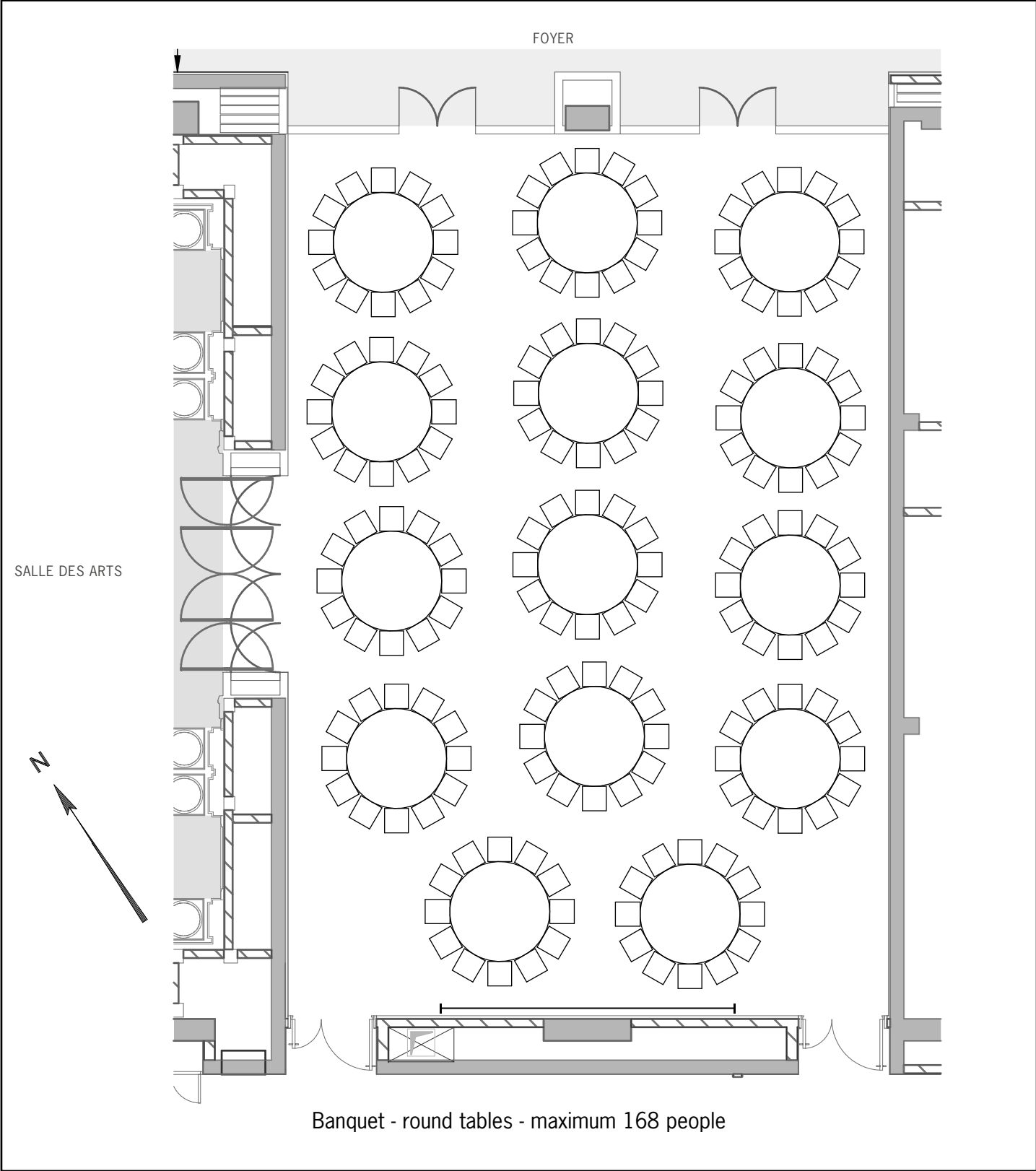

For technical information, please refer to general floorplan (without set-up)

Scale : 1/100

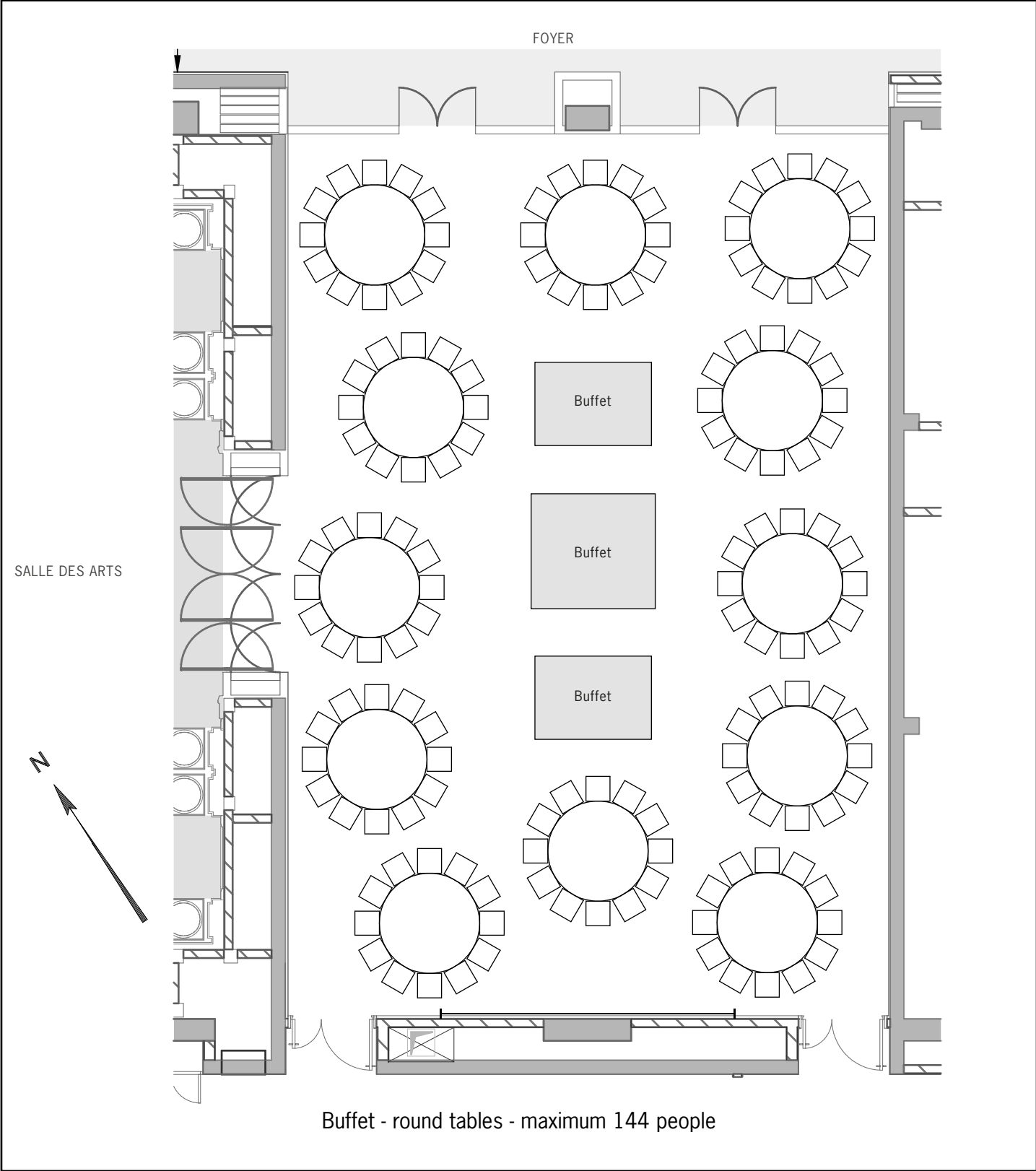

For technical information, please refer to general floorplan (without set-up)