

Salon Arman

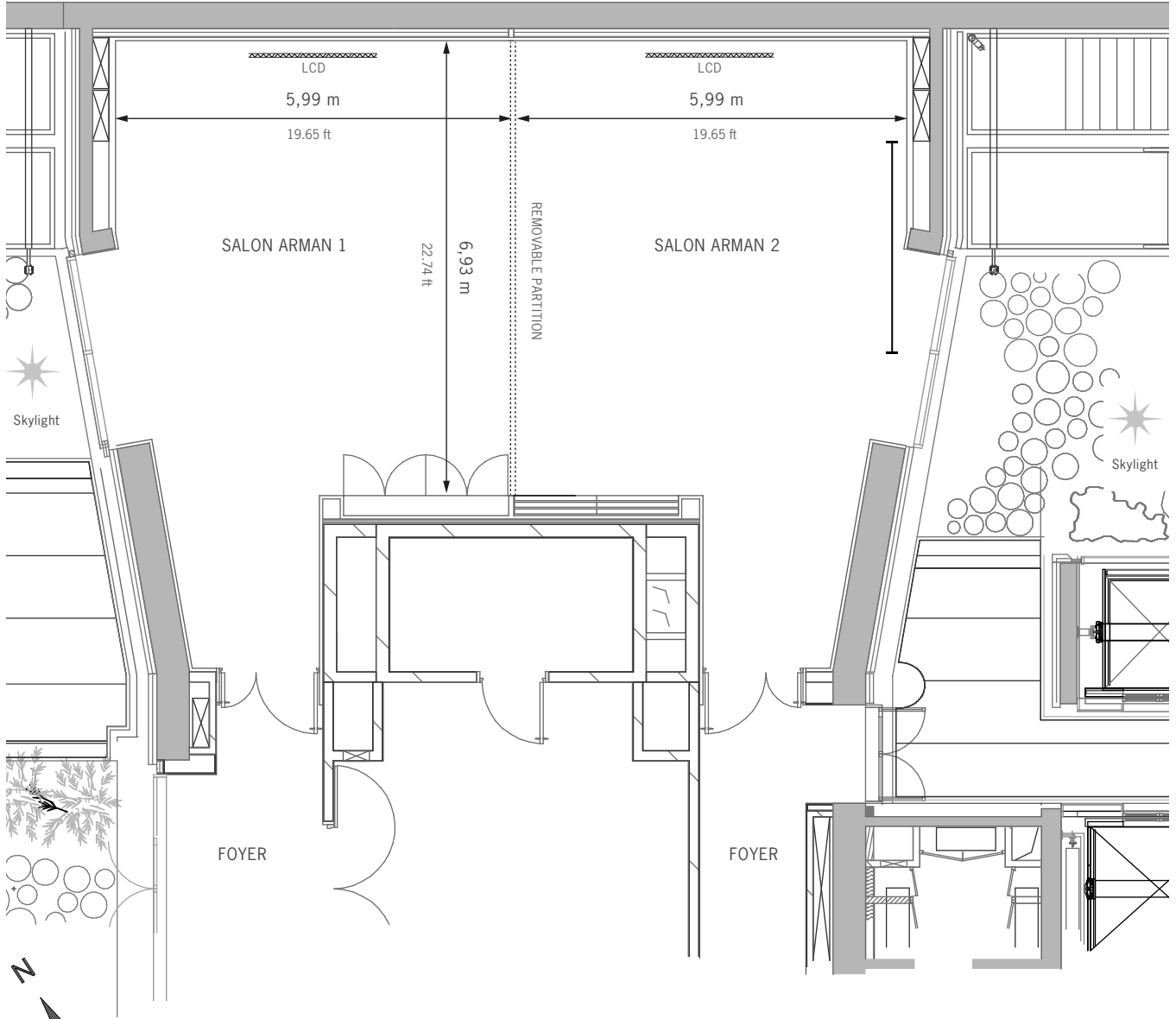

Legend

Scale: 1/200

Level : - 3
Height to ceiling: 3,05 m / 10.01 ft

Salon Arman area: 96 sq m / 1,033 sq ft
Salon Arman 1 area: 48 sq m / 517 sq ft
Salon Arman 2 area: 48 sq m / 517 sq ft

- retractable screen
- LCD screen
- removable partition
- daylight

ONE.MC.S.AR.1.GB-09-19 NON CONTRACTUAL

	Board	Cabaret	Classroom	Theatre	U-shape	Hollow Square	Banquet	Cocktail
SALON ARMAN	30	42	36	80	33	-	60	80
SALON ARMAN 1	18	-	18	44	18	-	-	40
SALON ARMAN 2	18	-	18	44	18	-	-	40

Scale : 1/200

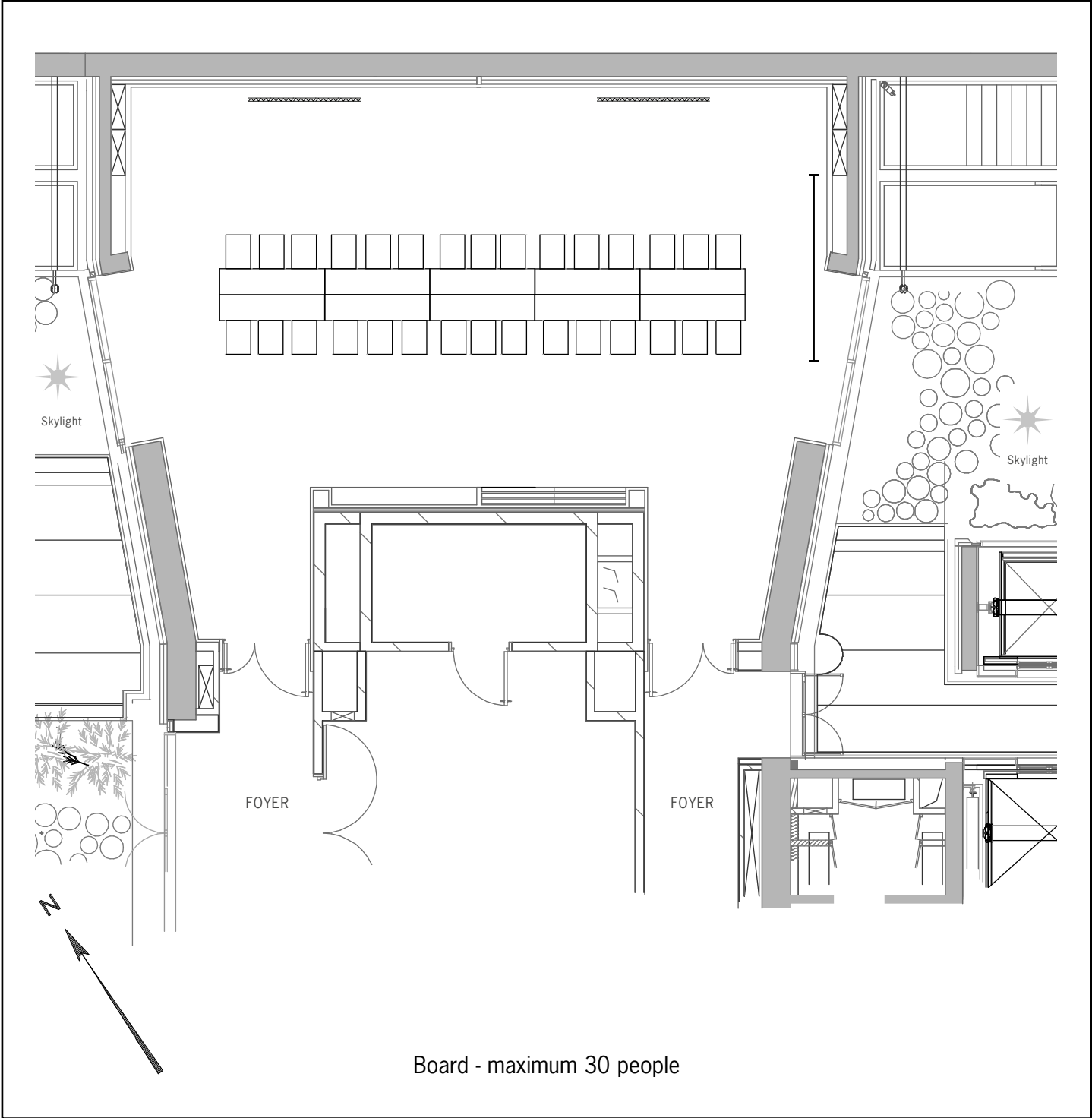

For technical information, please refer to general floorplan (without set-up)

Scale : 1/200

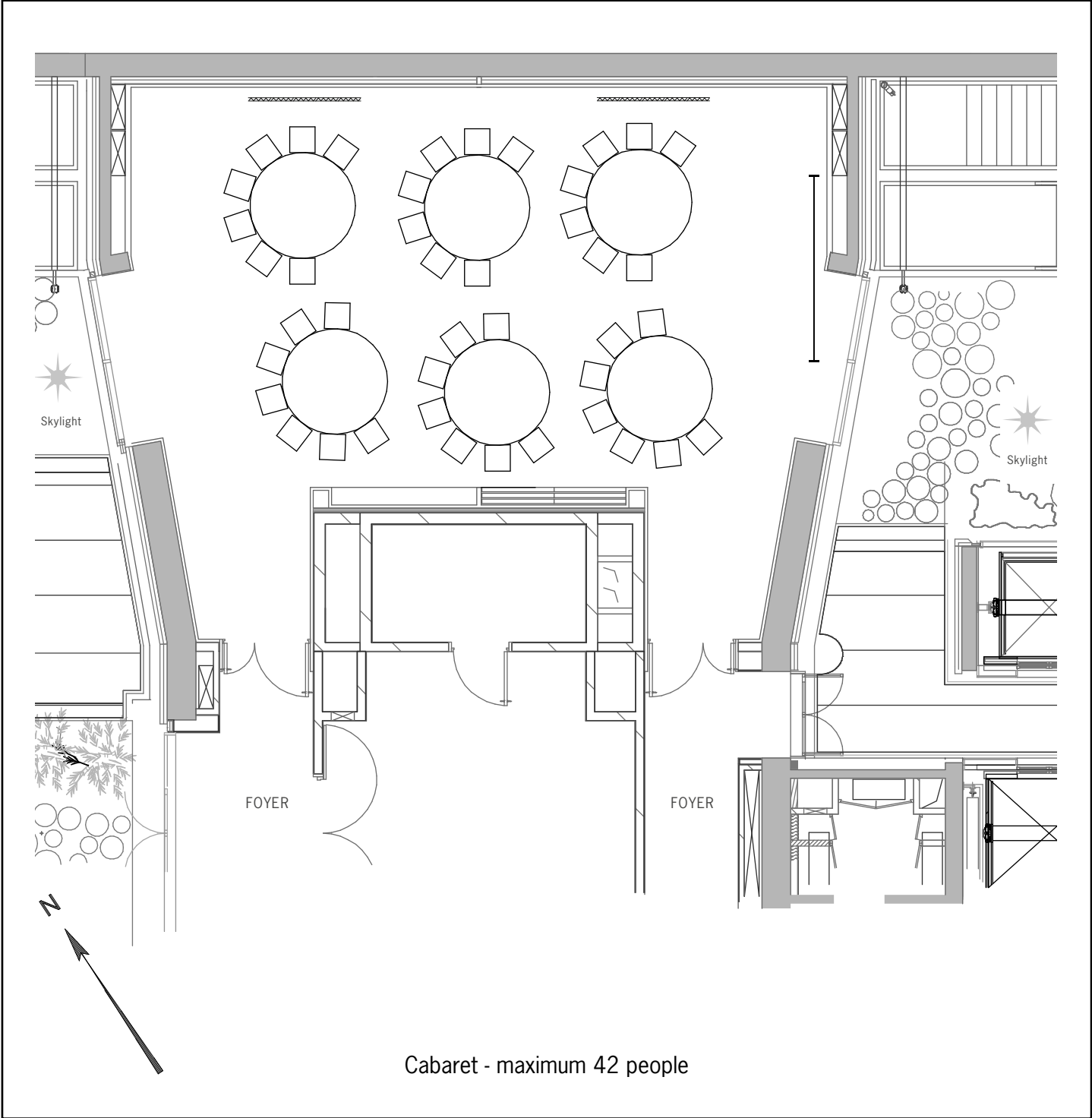

For technical information, please refer to general floorplan (without set-up)

Scale : 1/200

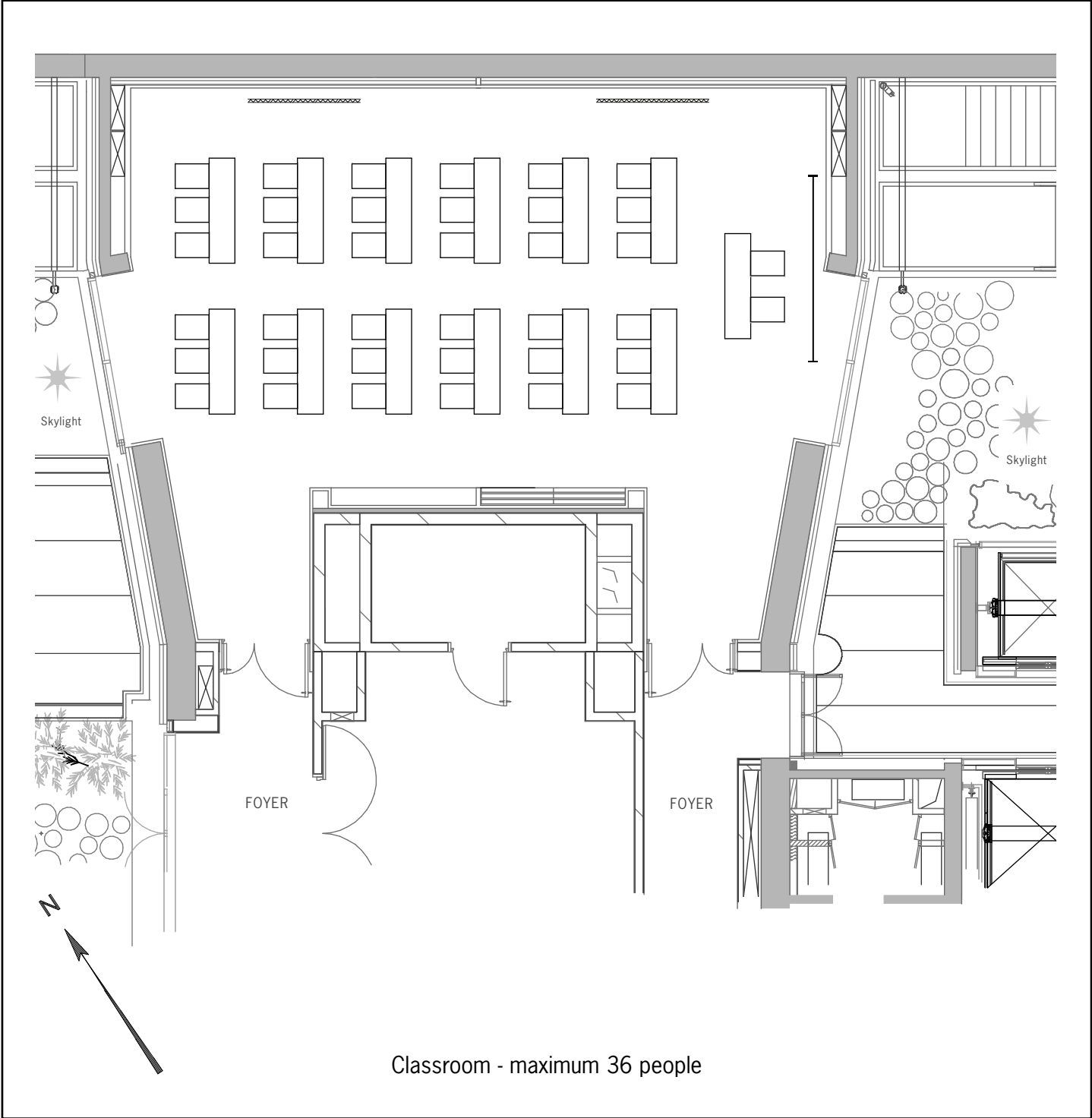

For technical information, please refer to general floorplan (without set-up)

Scale : 1/200

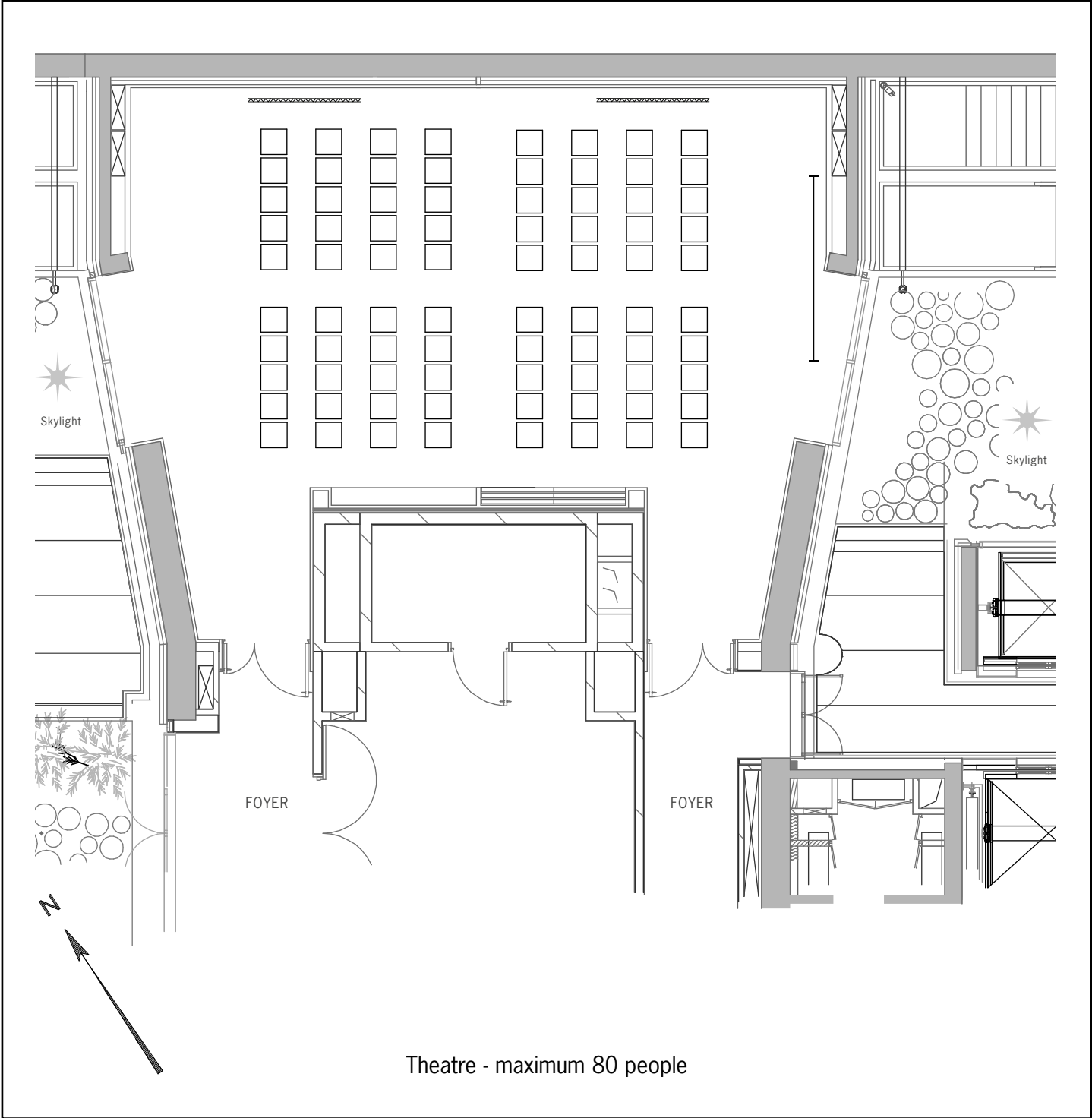

For technical information, please refer to general floorplan (without set-up)

Scale : 1/200

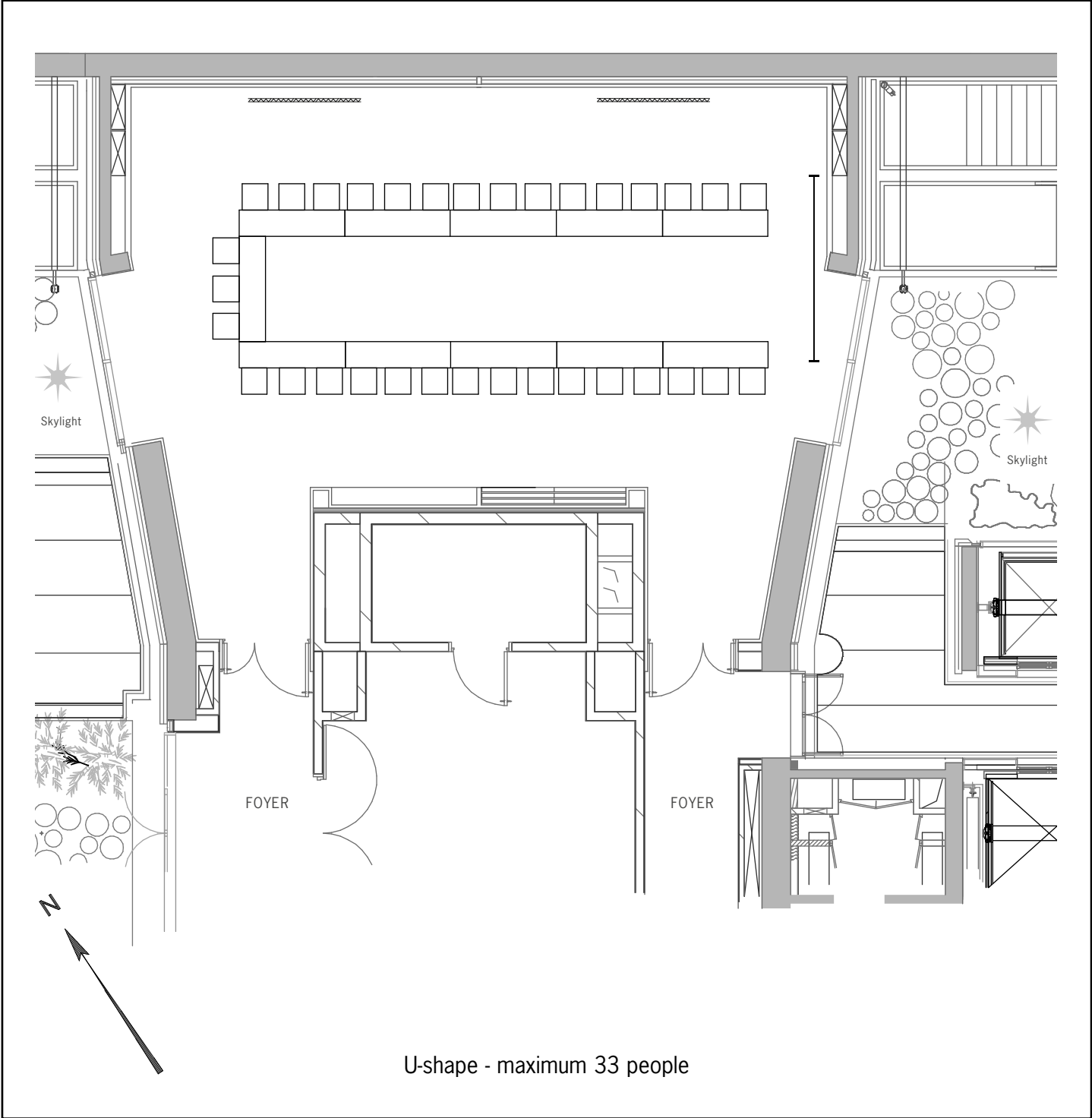

For technical information, please refer to general floorplan (without set-up)

Scale : 1/200

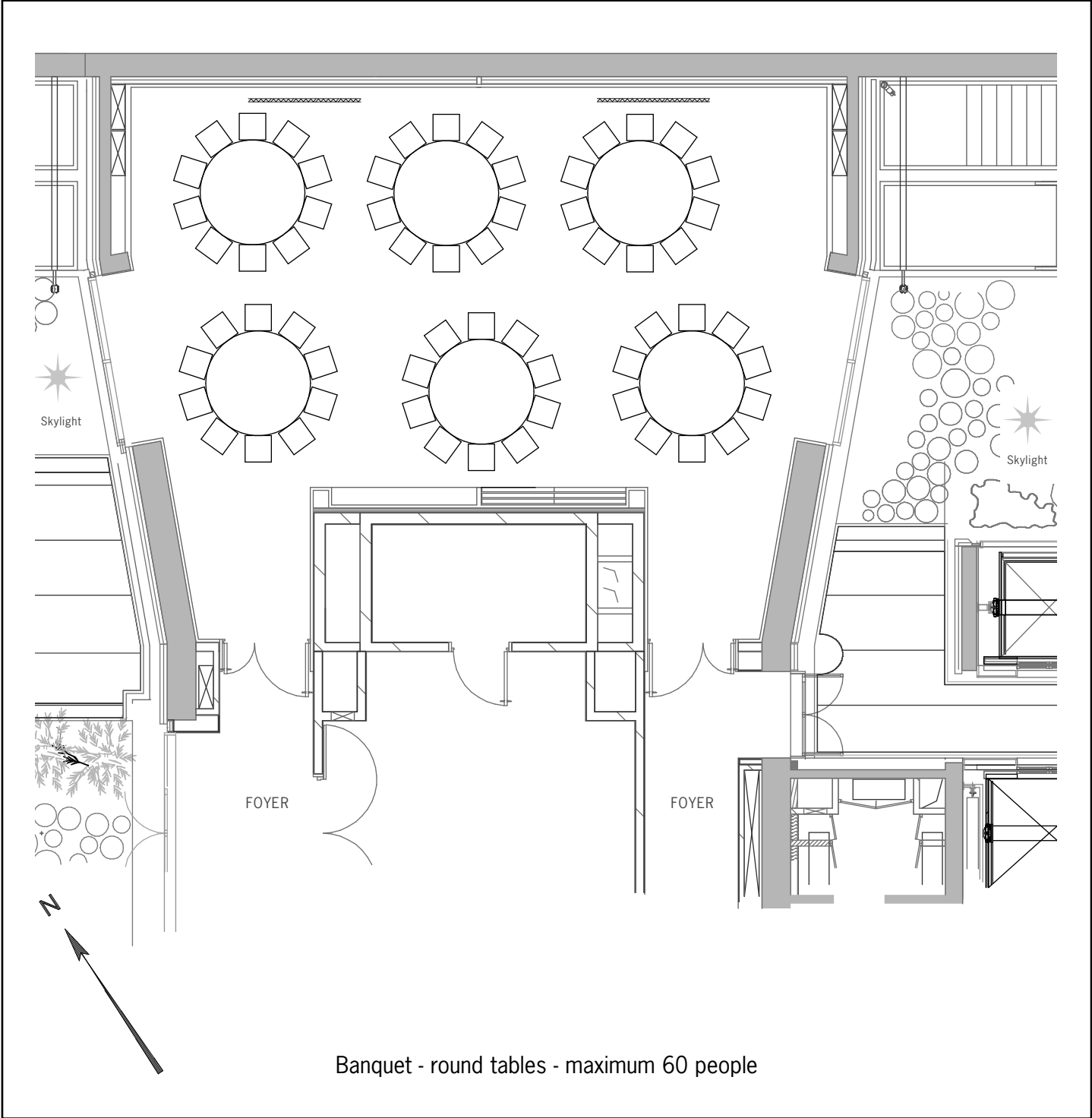

For technical information, please refer to general floorplan (without set-up)

Scale : 1/200

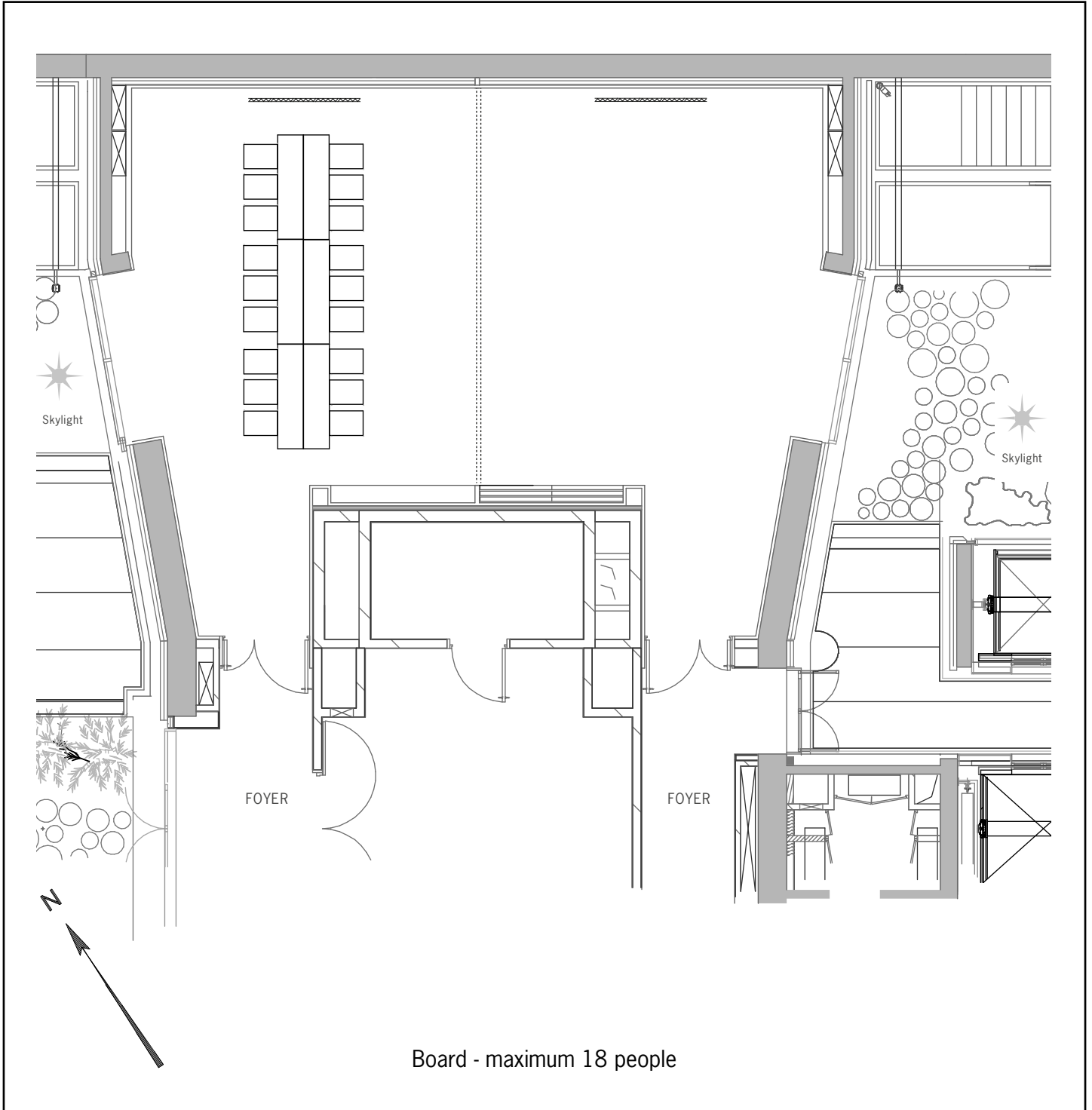

For technical information, please refer to general floorplan (without set-up)

Scale : 1/200

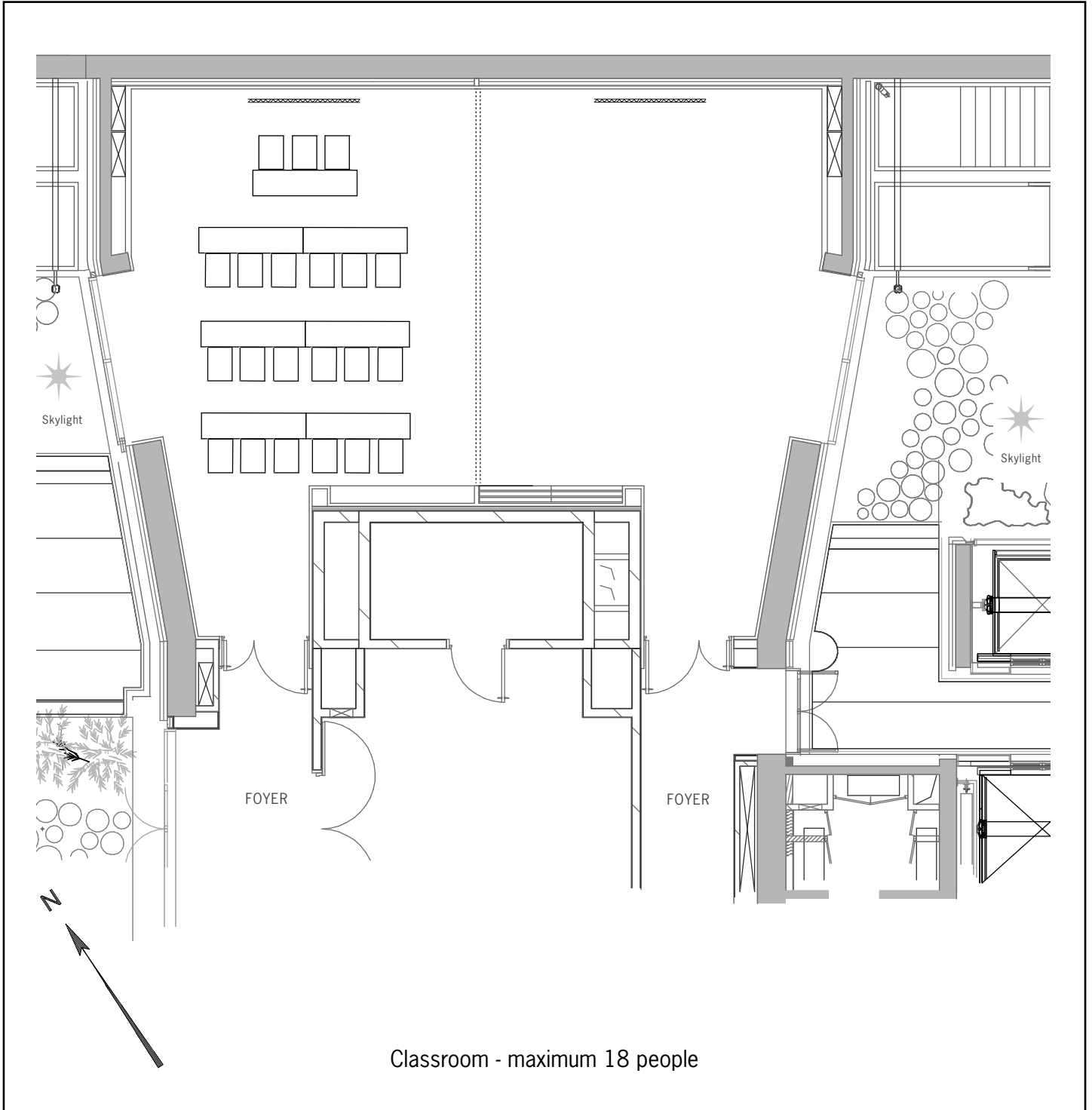

For technical information, please refer to general floorplan (without set-up)

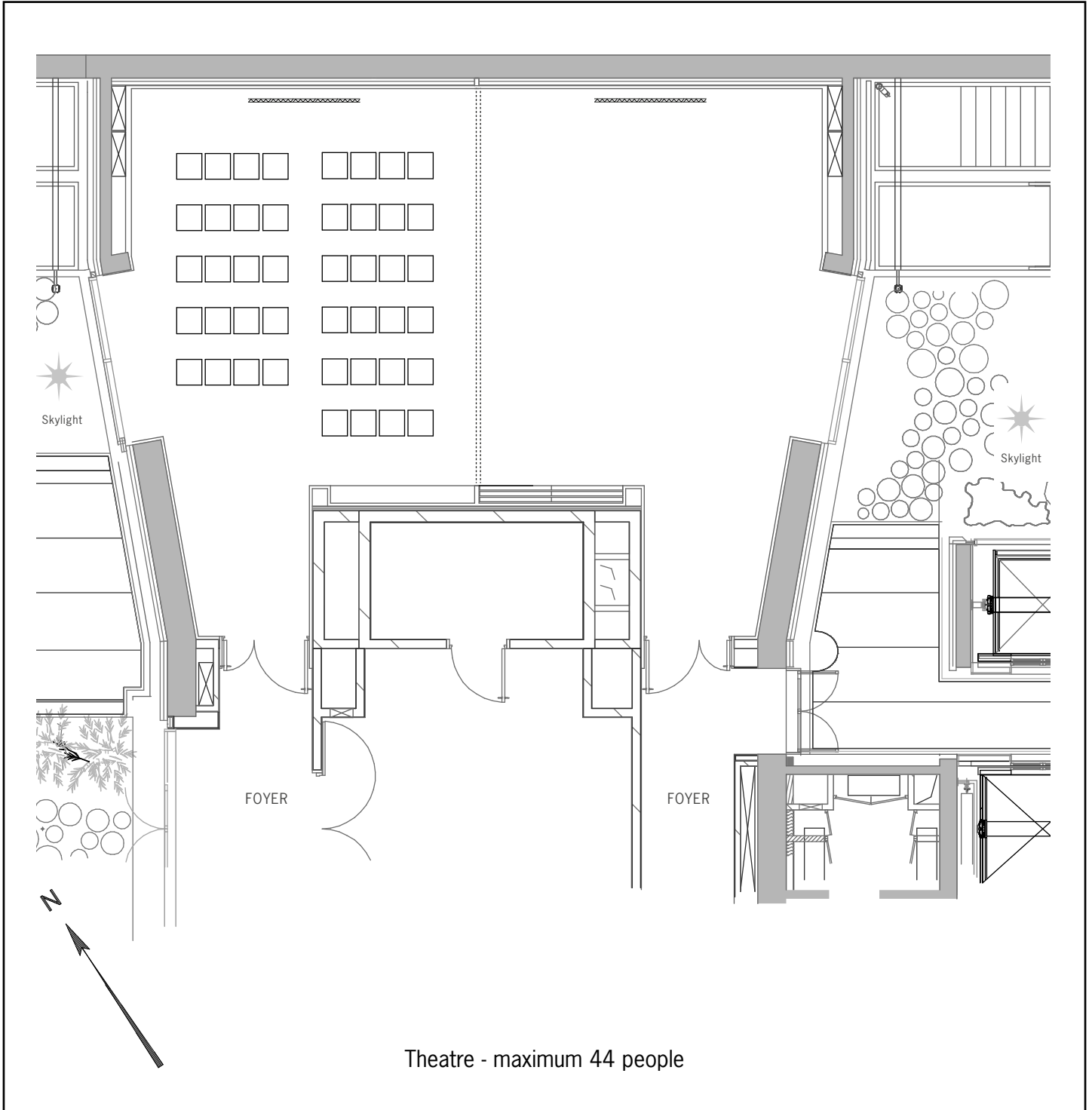

For technical information, please refer to general floorplan (without set-up)

Salon Arman 1

Scale : 1/200

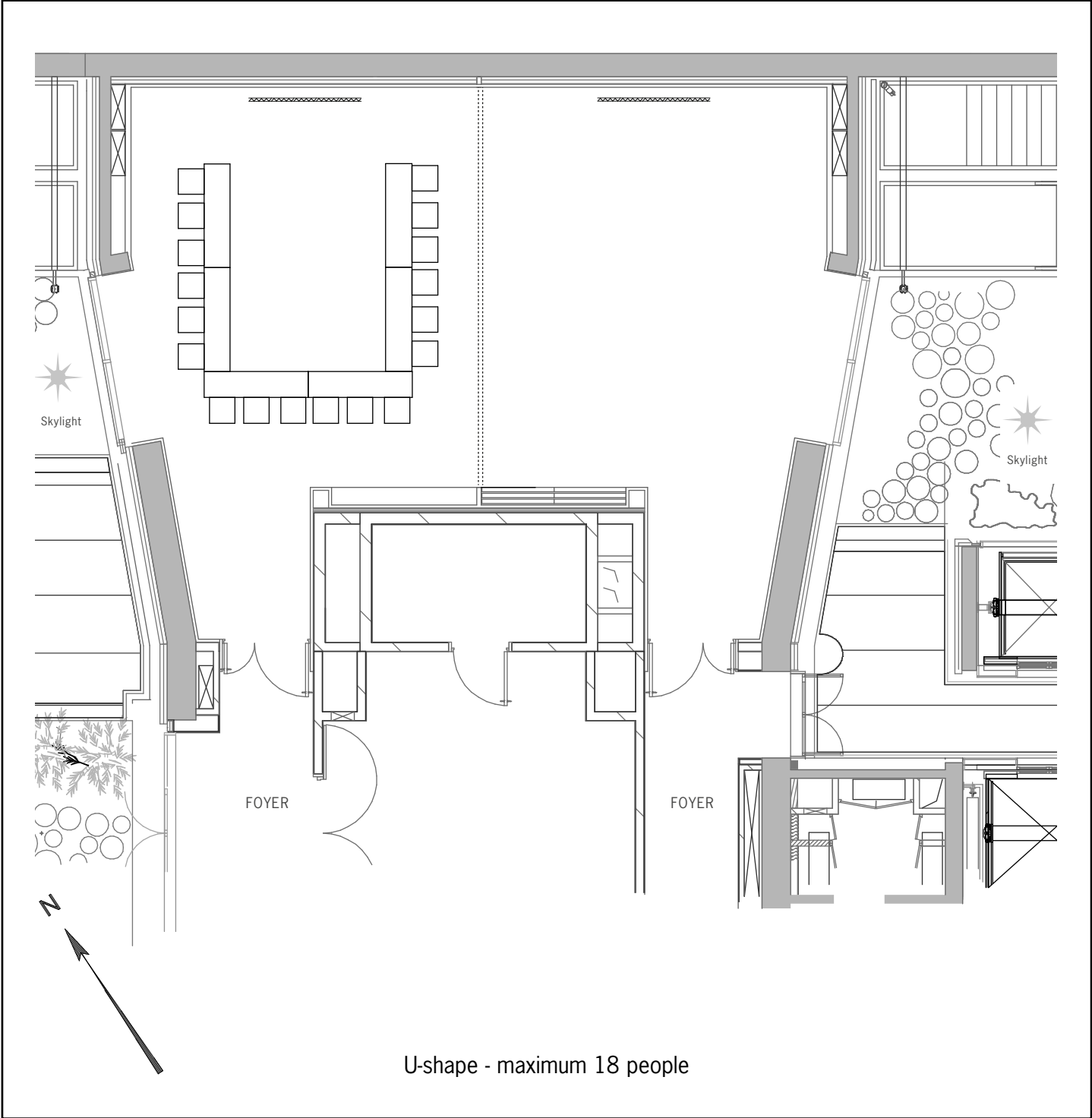

U-shape - maximum 18 people

For technical information, please refer to general floorplan (without set-up)

Salon Arman 2

Scale : 1/200

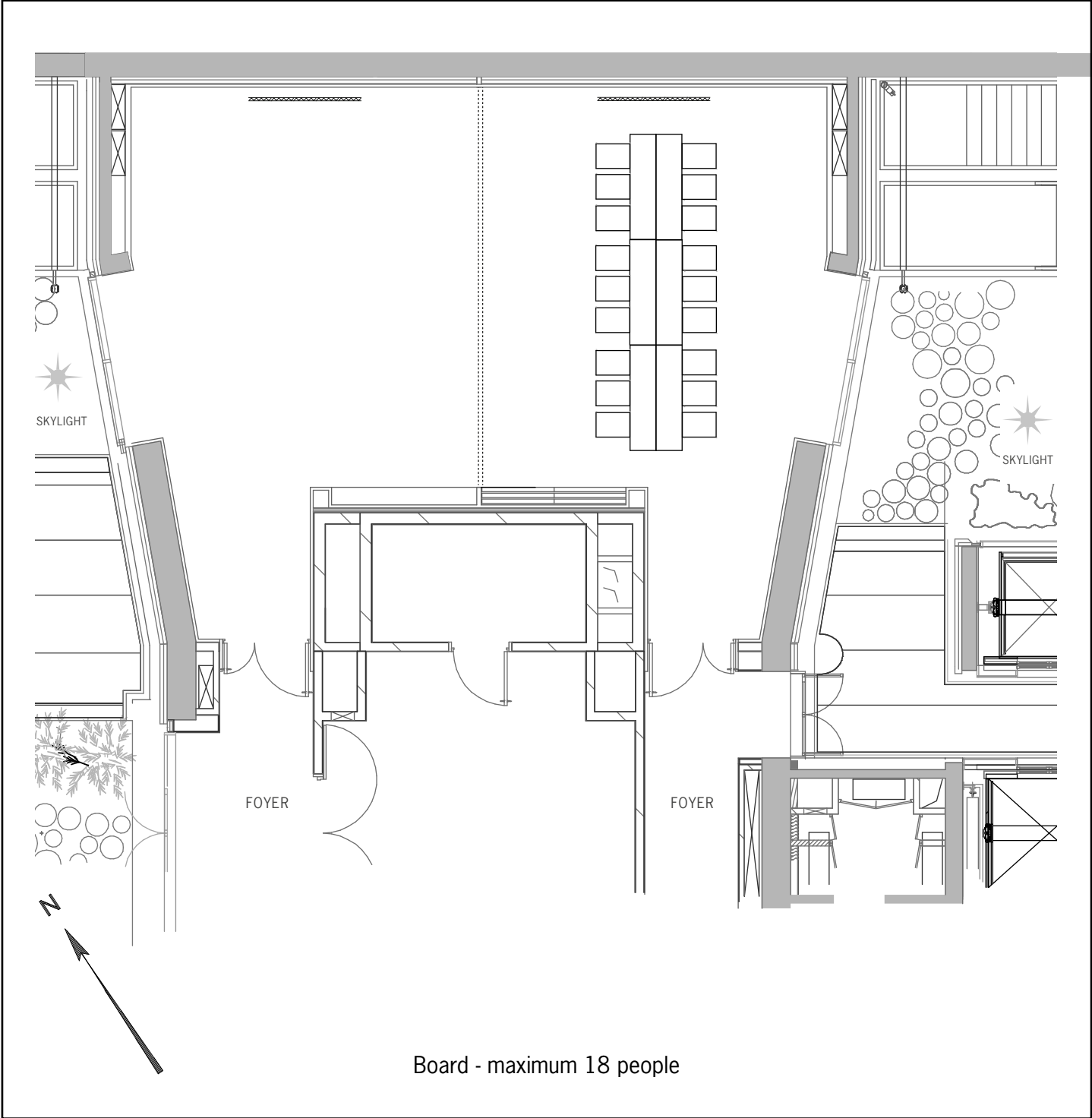

For technical information, please refer to general floorplan (without set-up)

Salon Arman 2

Scale : 1/200

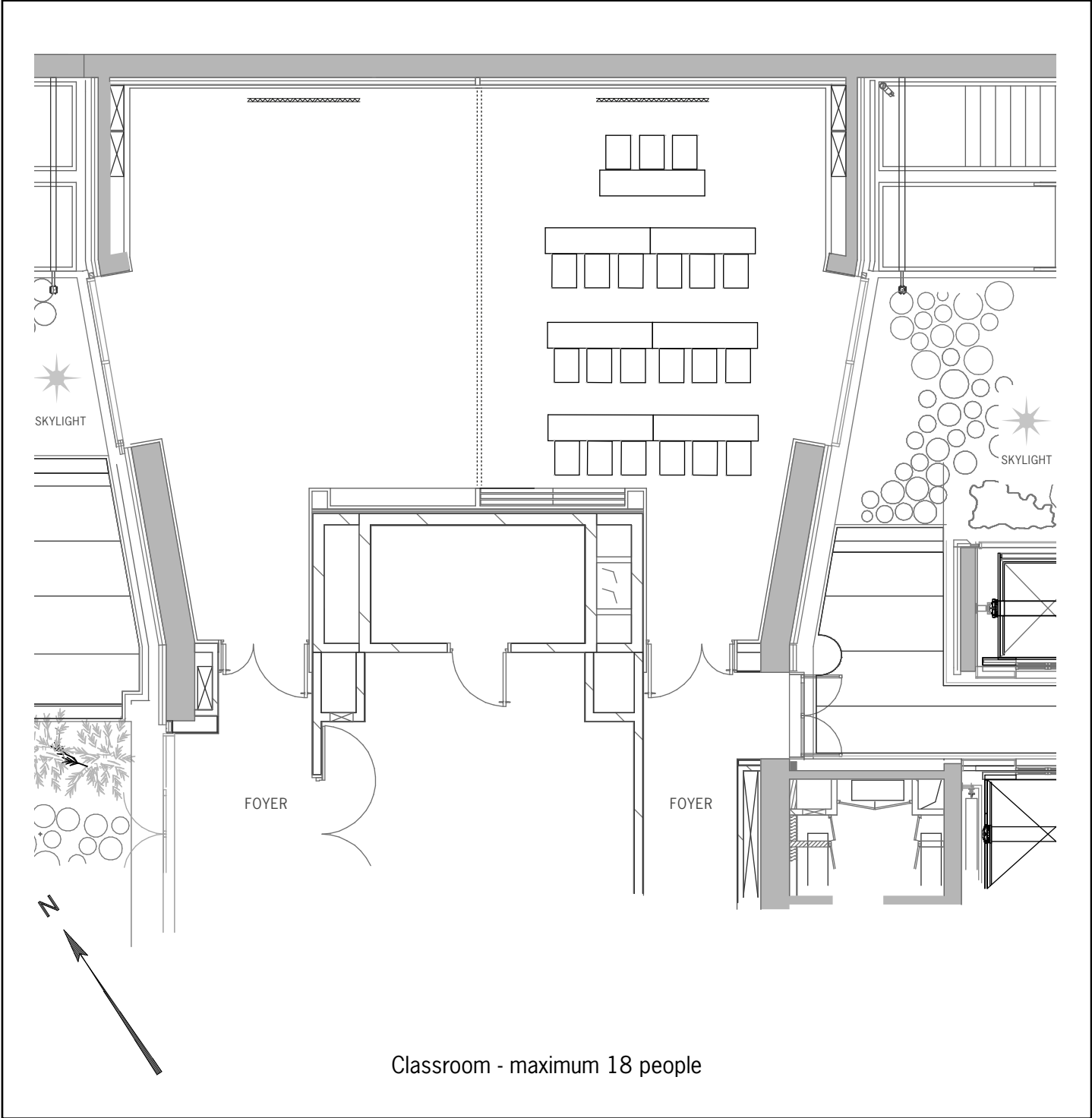

For technical information, please refer to general floorplan (without set-up)

Scale : 1/200

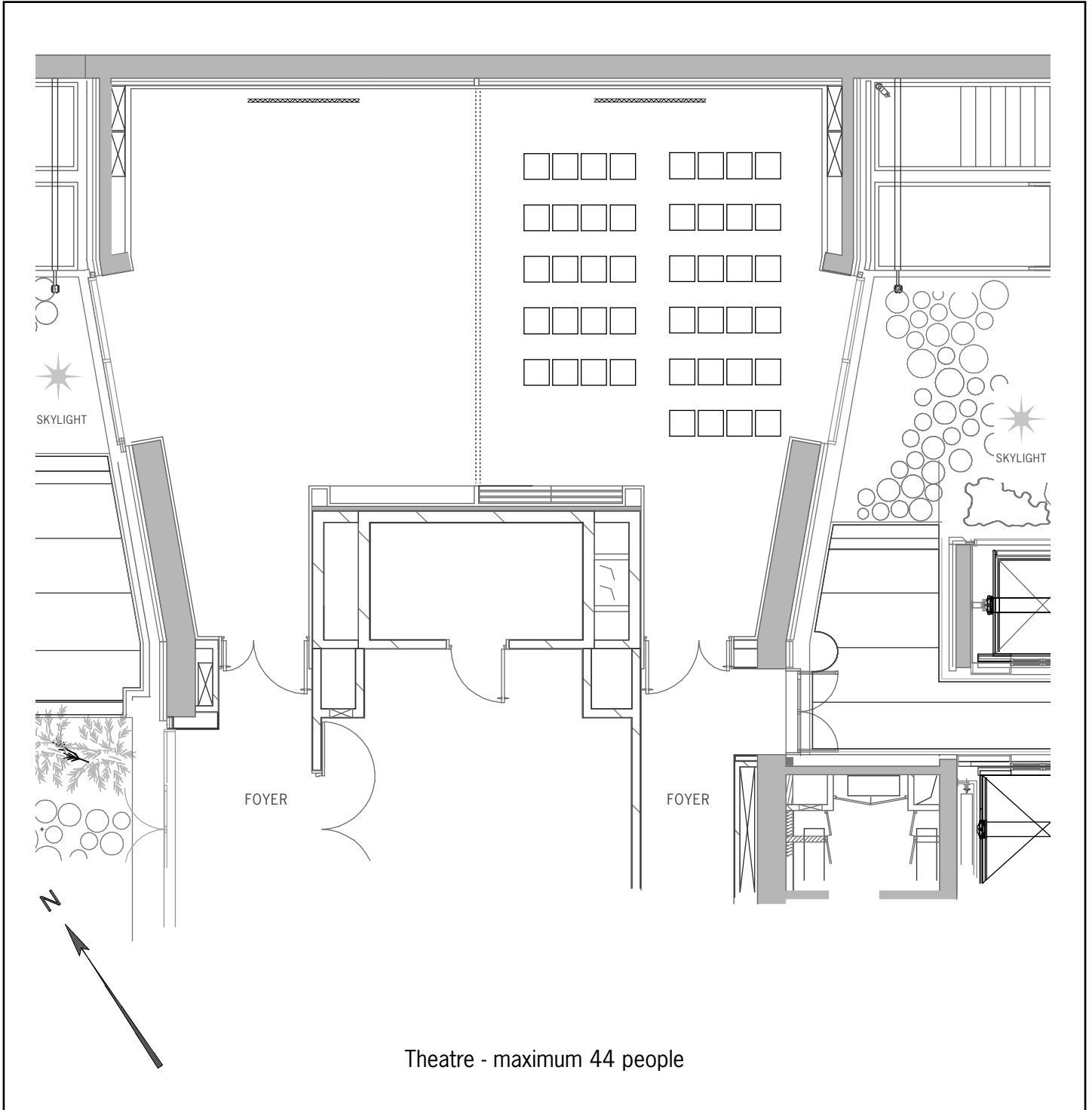

For technical information, please refer to general floorplan (without set-up)

Scale : 1/200

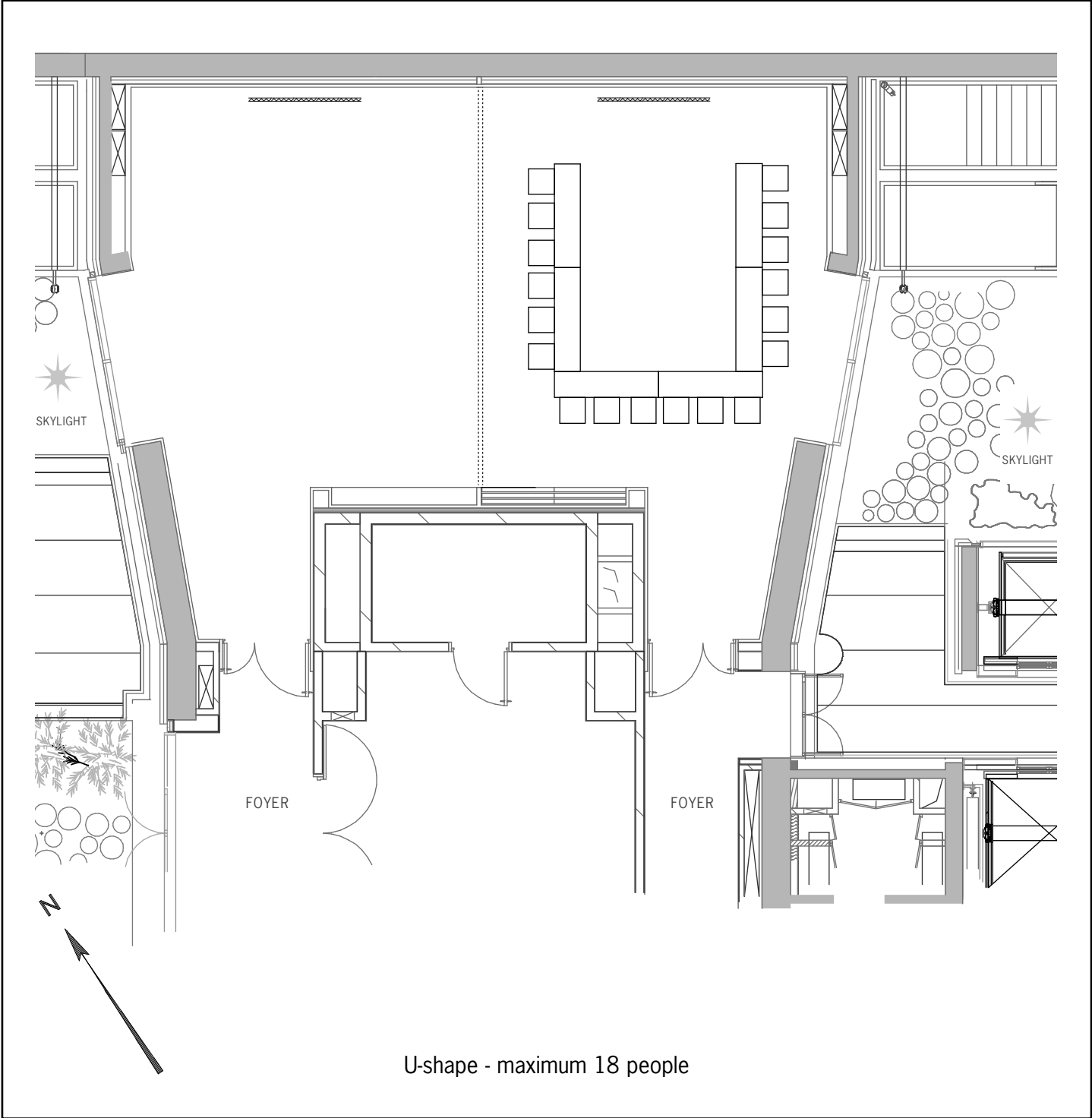

For technical information, please refer to general floorplan (without set-up)