

Legend

Level: 1st floor
 Orientation: south
 Height to ceiling: 3,30 m / 10.8 ft
 Columbia area: 324 sq m / 3,487.5 sq ft
 Clever area: 121 sq m / 1,302.4 sq ft
 Créole area: 120 sq m / 1,291.7 sq ft
 Cambria area: 83 sq m / 893.4 sq ft

⊙ 220v wall sockets
 ☒ electrical box with power outlet
 removable partition
 ✨ daylight

Scale: 1/200



| | Board | Cabaret | Classroom | Theatre | U-shape | Hollow Square | Banquet | Cocktail |
|----------------|-------|---------|-----------|---------|---------|---------------|---------|----------|
| SALLE COLUMBIA | 52 | 78 | 90 | 150 | 50 | 58 | 234 | 300 |
| SALON CAMBRIA | 28 | 24 | 28 | 54 | 24 | 34 | 45 | 40 |
| SALON CLEVER | 40 | 42 | 56 | 100 | 36 | 46 | 72 | 80 |
| SALON CRÉOLE | 40 | 42 | 56 | 100 | 36 | 46 | 72 | 80 |

Scale : 1/200

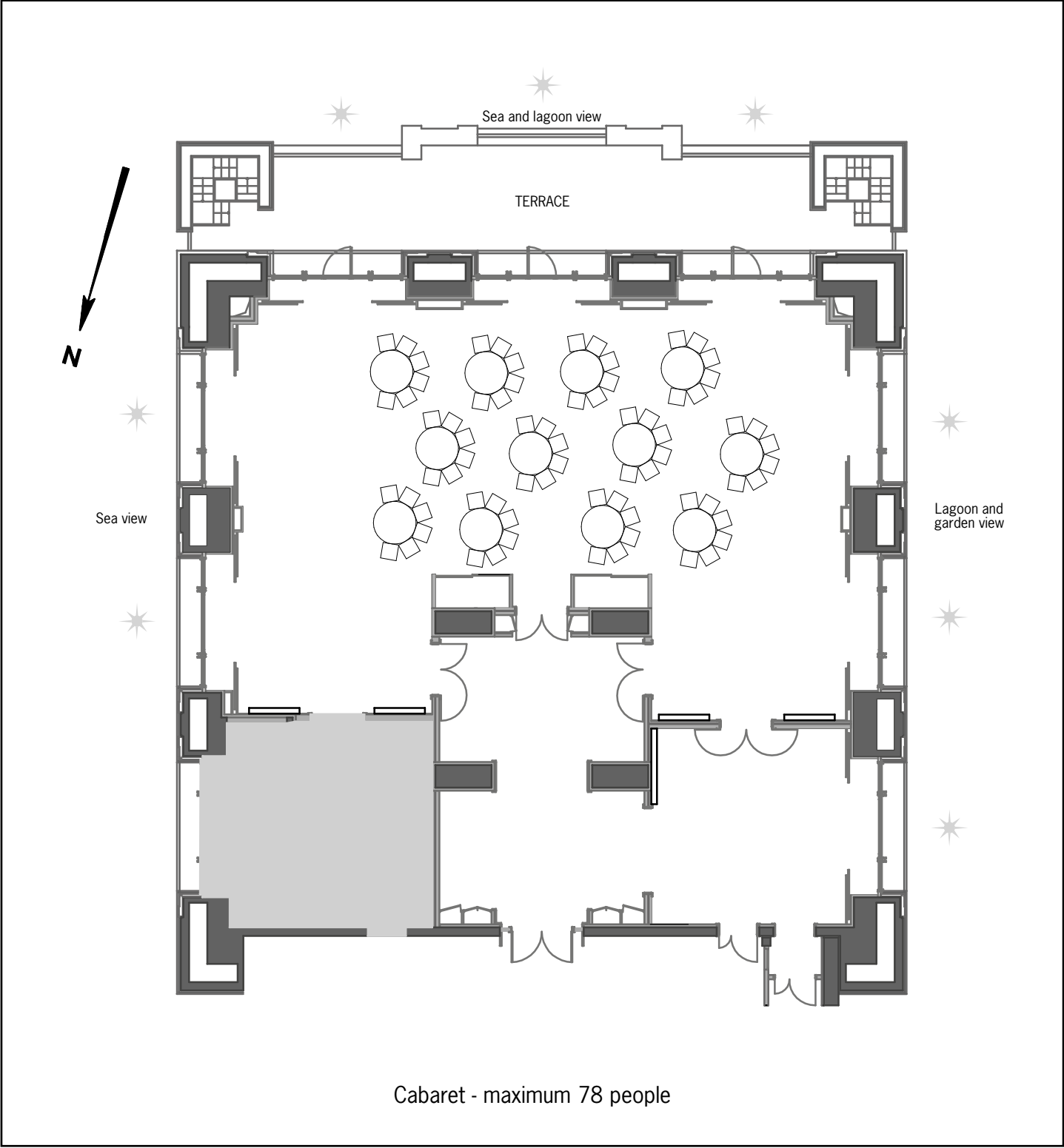

For technical information, please refer to general floorplan (without set-up)

Scale : 1/200

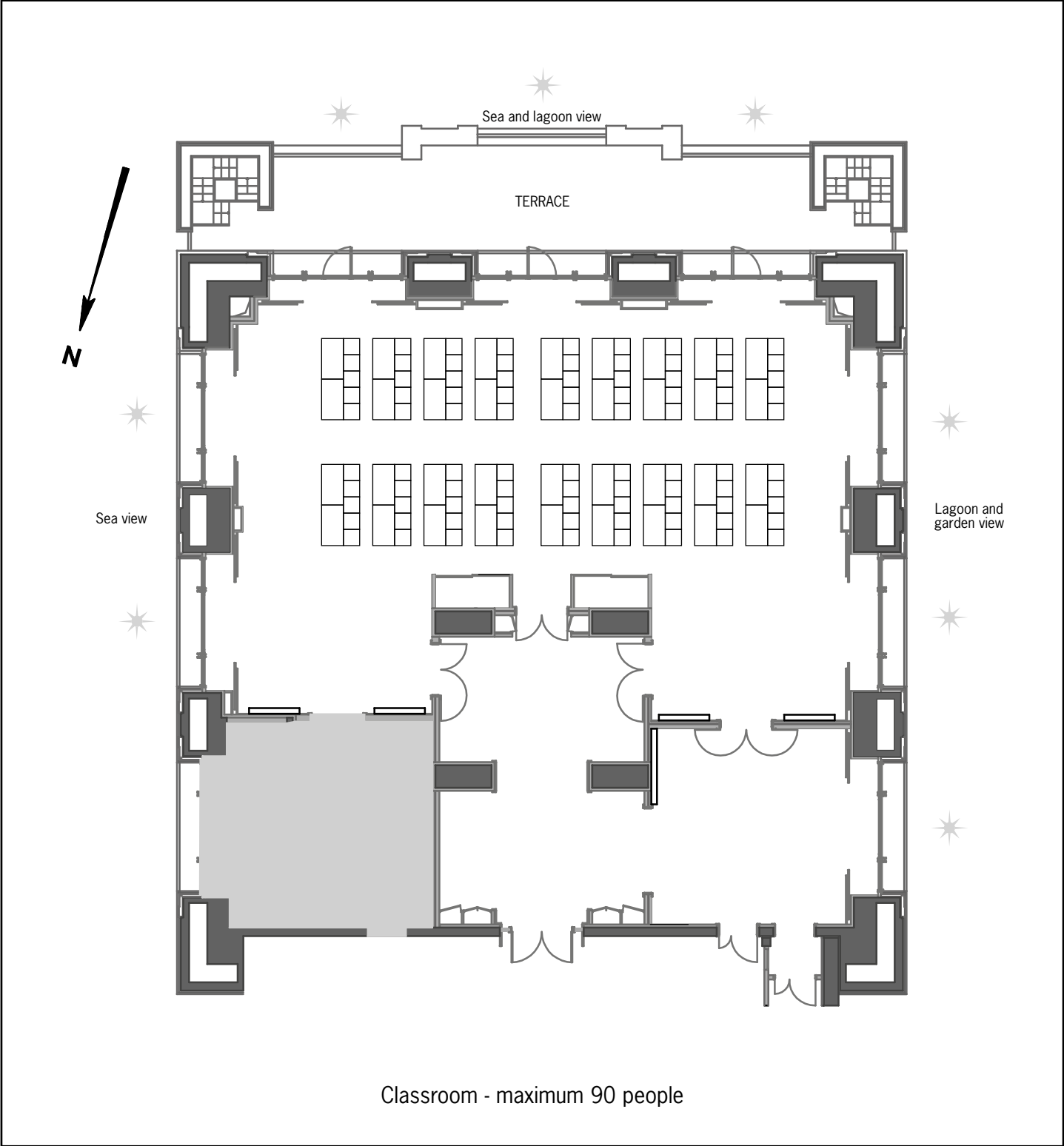

For technical information, please refer to general floorplan (without set-up)

Scale : 1/200

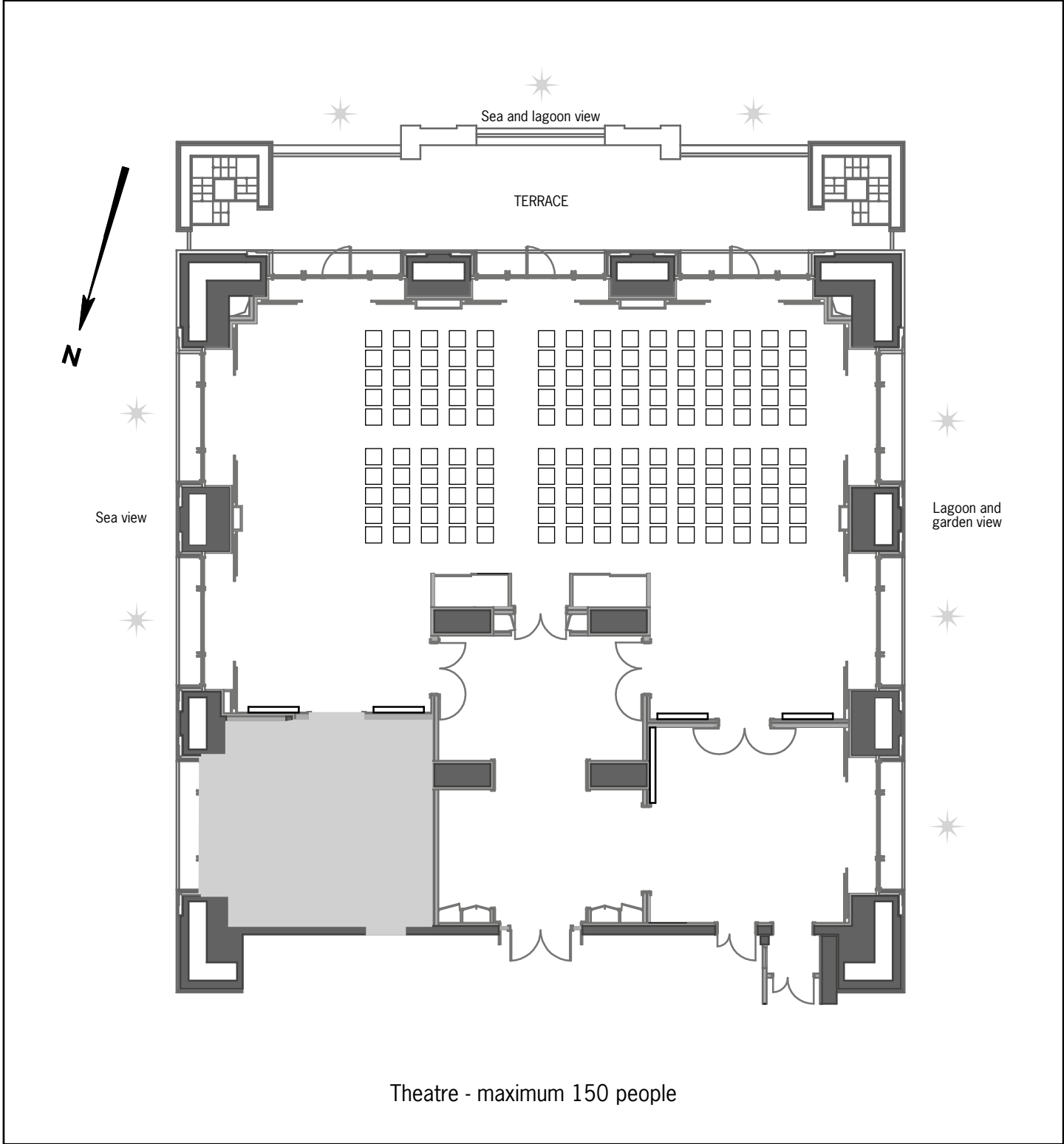

For technical information, please refer to general floorplan (without set-up)

Scale : 1/200

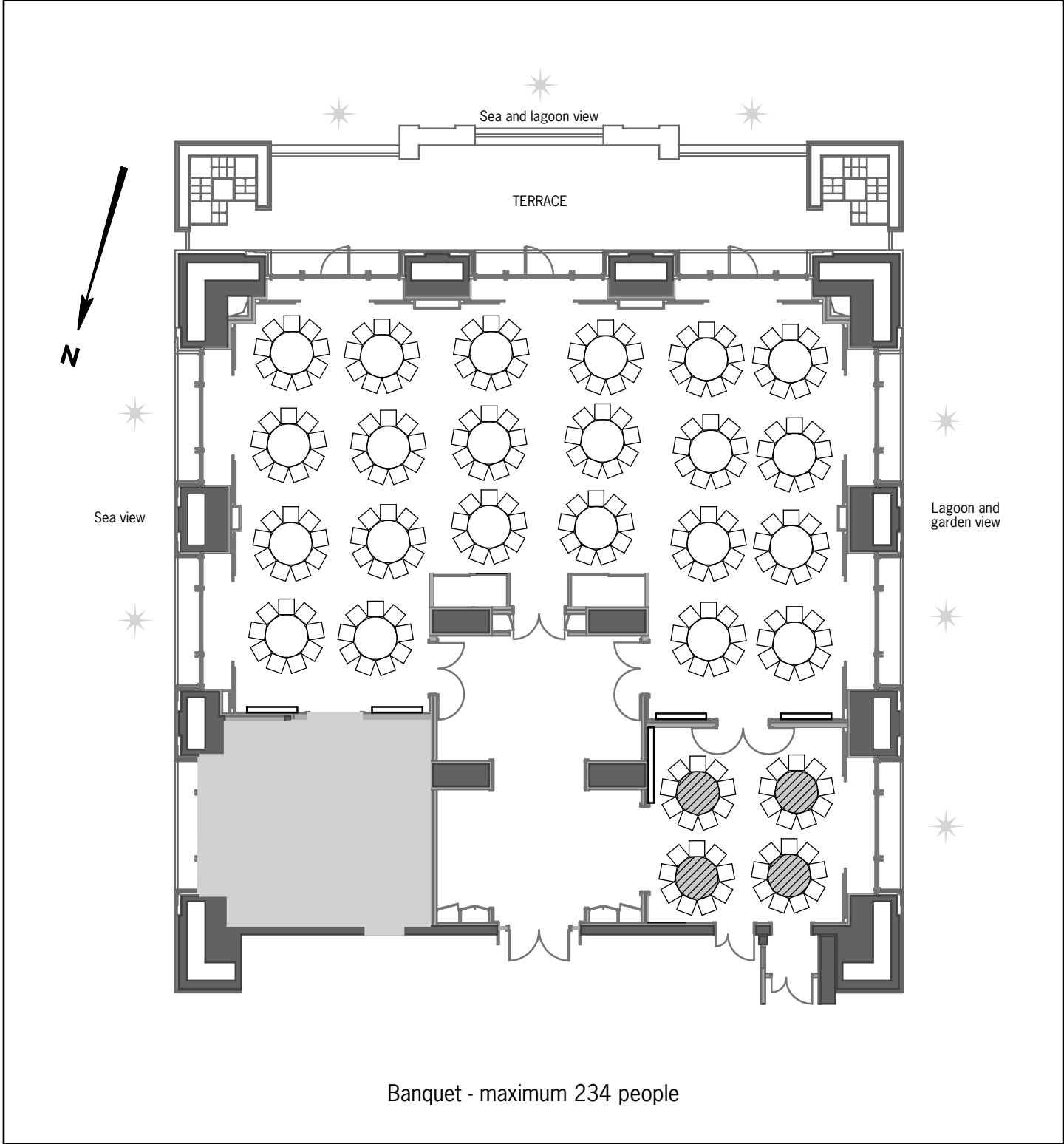

For technical information, please refer to general floorplan (without set-up)

Scale : 1/200

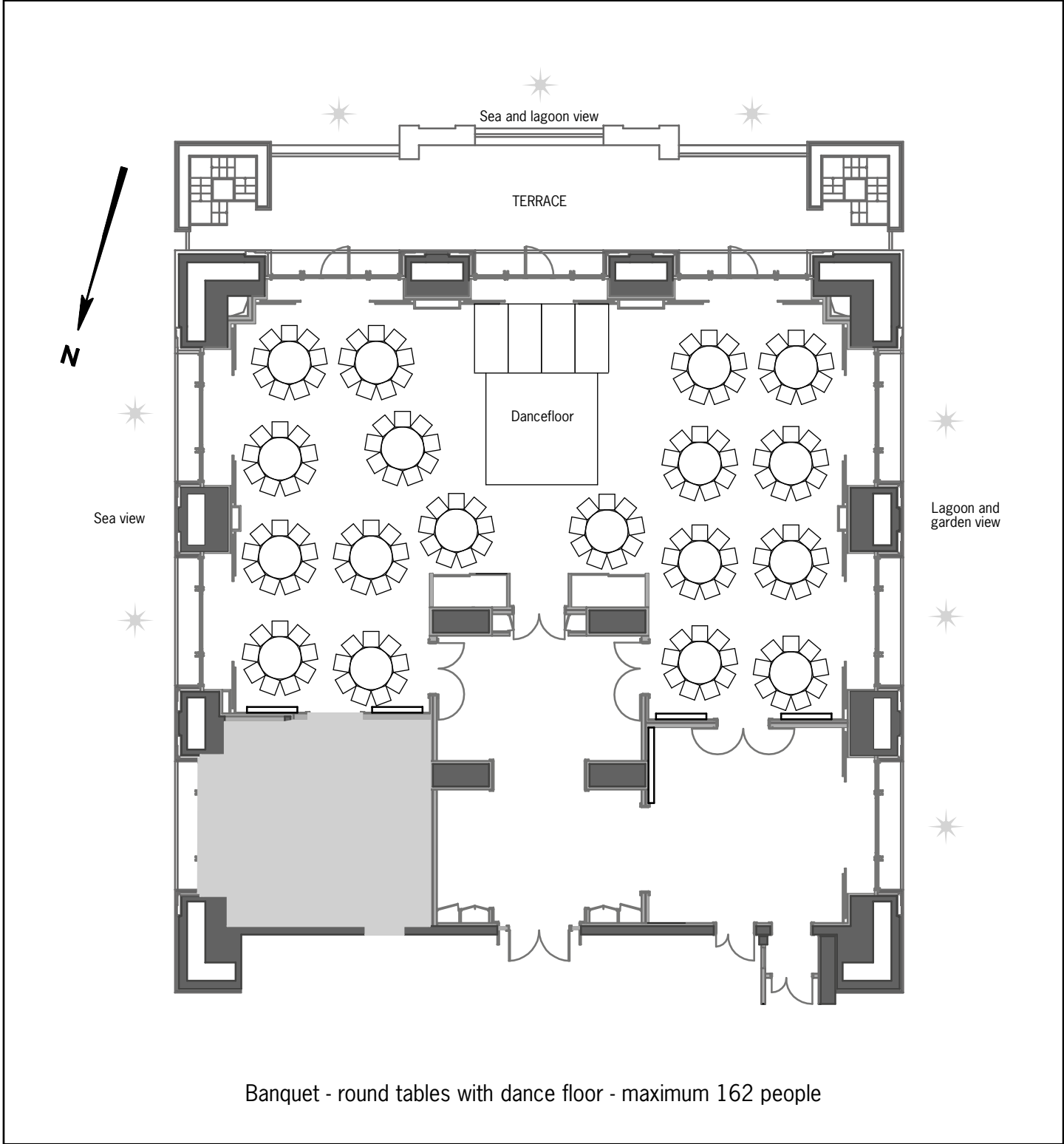

For technical information, please refer to general floorplan (without set-up)