

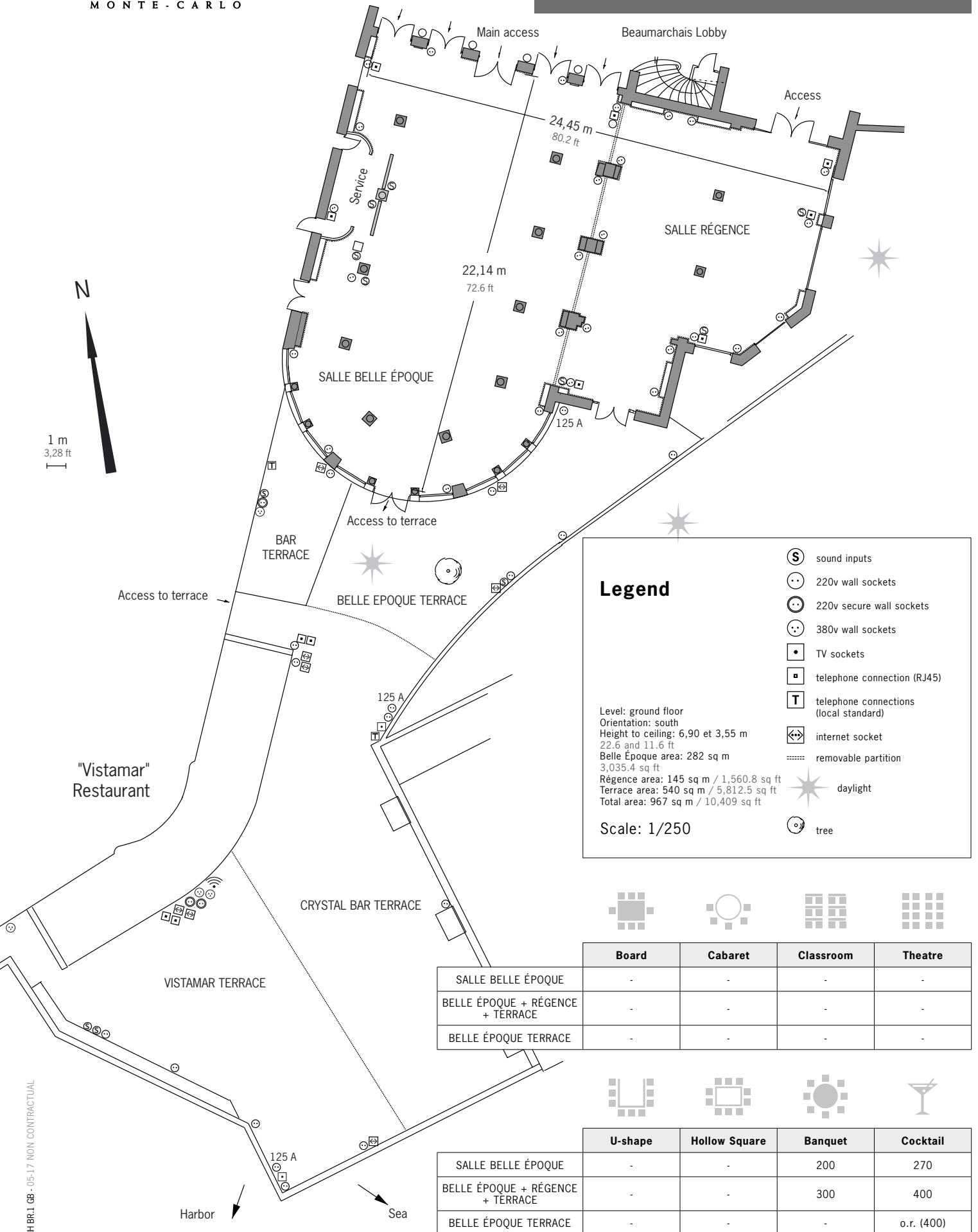

# HÔTEL HERMITAGE

MONTE-CARLO

# Salle Belle Époque, Régence and terrace



## Legend

- sound inputs
- 220v wall sockets
- 220v secure wall sockets
- 380v wall sockets
- TV sockets
- telephone connection (RJ45)
- telephone connections (local standard)
- internet socket
- removable partition
- daylight
- tree

Level: ground floor  
 Orientation: south  
 Height to ceiling: 6,90 et 3,55 m  
 22.6 and 11.6 ft  
 Belle Époque area: 282 sq m  
 3,035.4 sq ft  
 Régence area: 145 sq m / 1,560.8 sq ft  
 Terrace area: 540 sq m / 5,812.5 sq ft  
 Total area: 967 sq m / 10,409 sq ft

Scale: 1/250

	Board	Cabaret	Classroom	Theatre
SALLE BELLE ÉPOQUE	-	-	-	-
BELLE ÉPOQUE + RÉGENCE + TERRACE	-	-	-	-
BELLE ÉPOQUE TERRACE	-	-	-	-

	U-shape	Hollow Square	Banquet	Cocktail
SALLE BELLE ÉPOQUE	-	-	200	270
BELLE ÉPOQUE + RÉGENCE + TERRACE	-	-	300	400
BELLE ÉPOQUE TERRACE	-	-	-	o.r. (400)



HÔTEL HERMITAGE

MONTE-CARLO

# Salle Belle Époque

Scale : 1/250

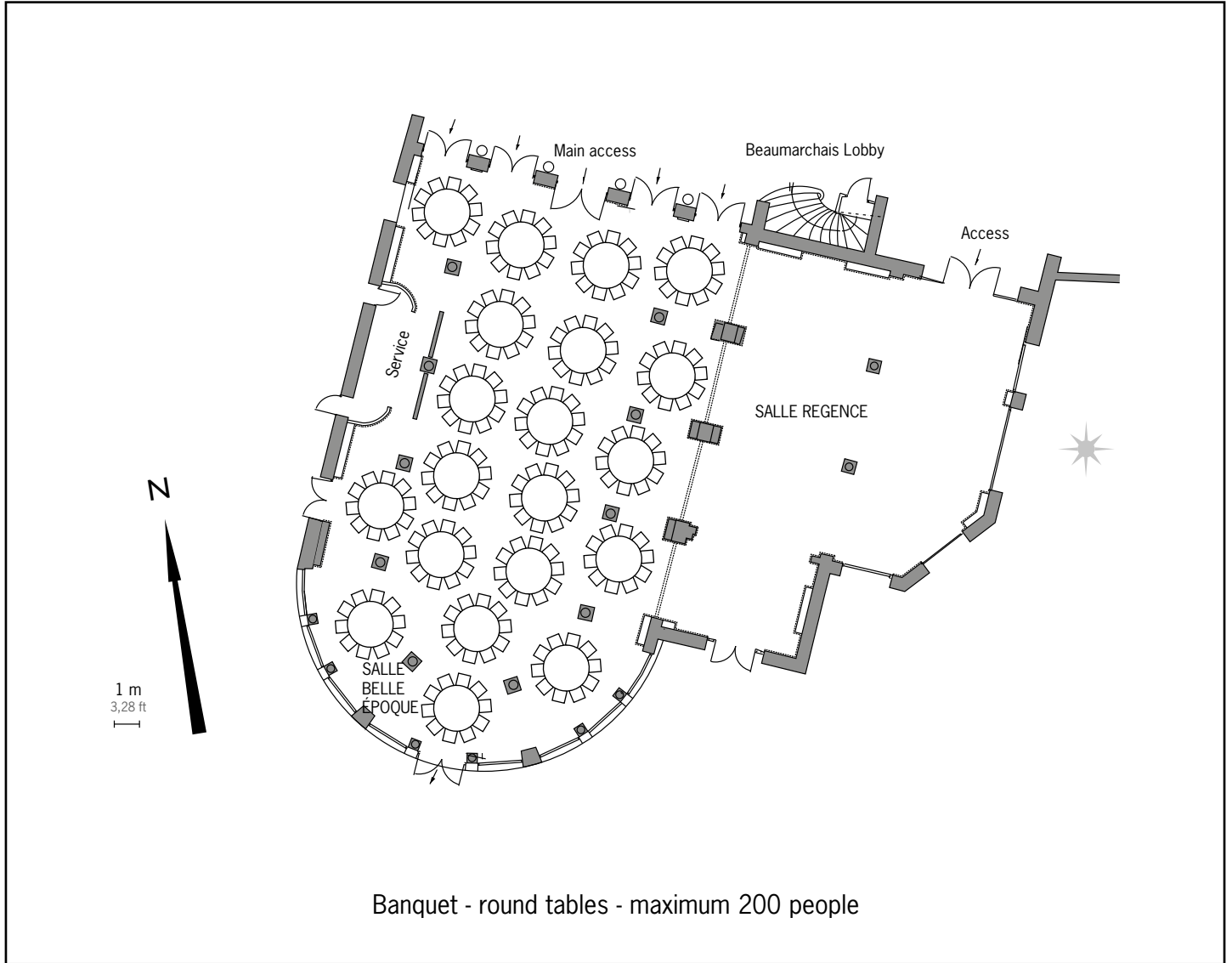

Banquet - round tables - maximum 200 people

For technical information, please refer to general floorplan (without set-up)



**HÔTEL HERMITAGE**

MONTE-CARLO

# Salles Belle Époque et Régence

Scale : 1/250

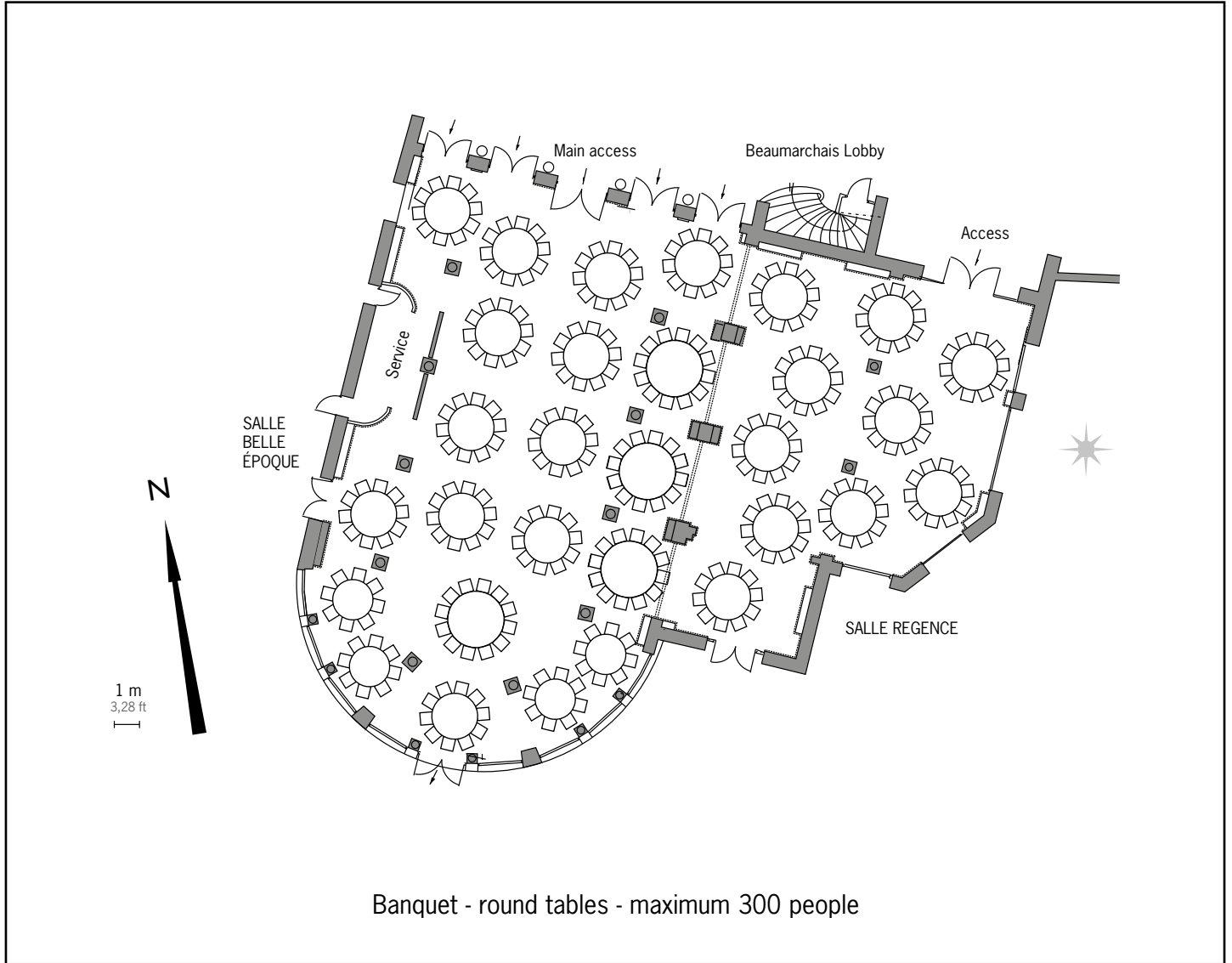

For technical information, please refer to general floorplan (without set-up)



HÔTEL HERMITAGE

MONTE-CARLO

# Salle Belle Époque

Scale : 1/250

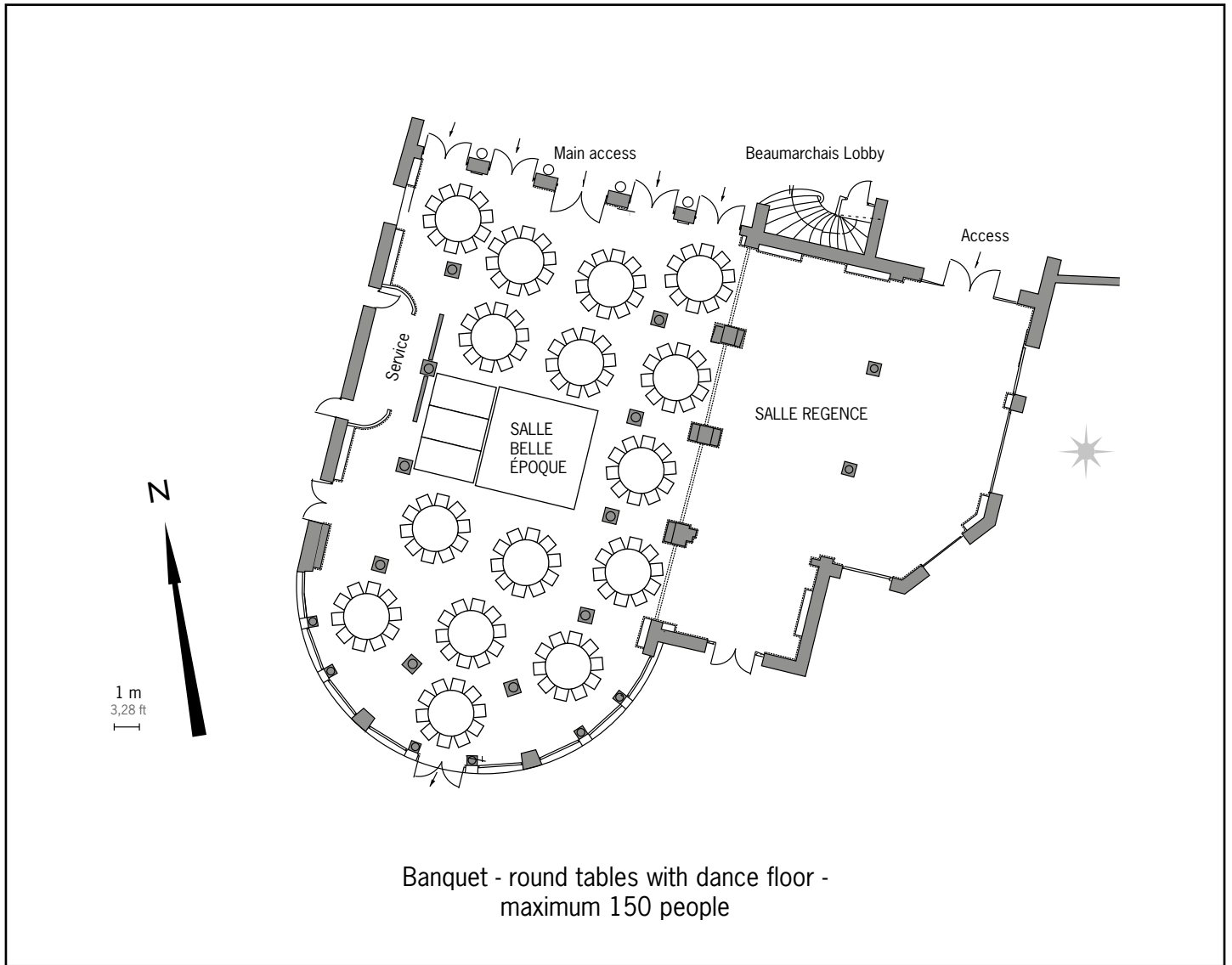

For technical information, please refer to general floorplan (without set-up)



**HÔTEL HERMITAGE**

MONTE-CARLO

# Salles Belle Époque et Régence

Scale : 1/250

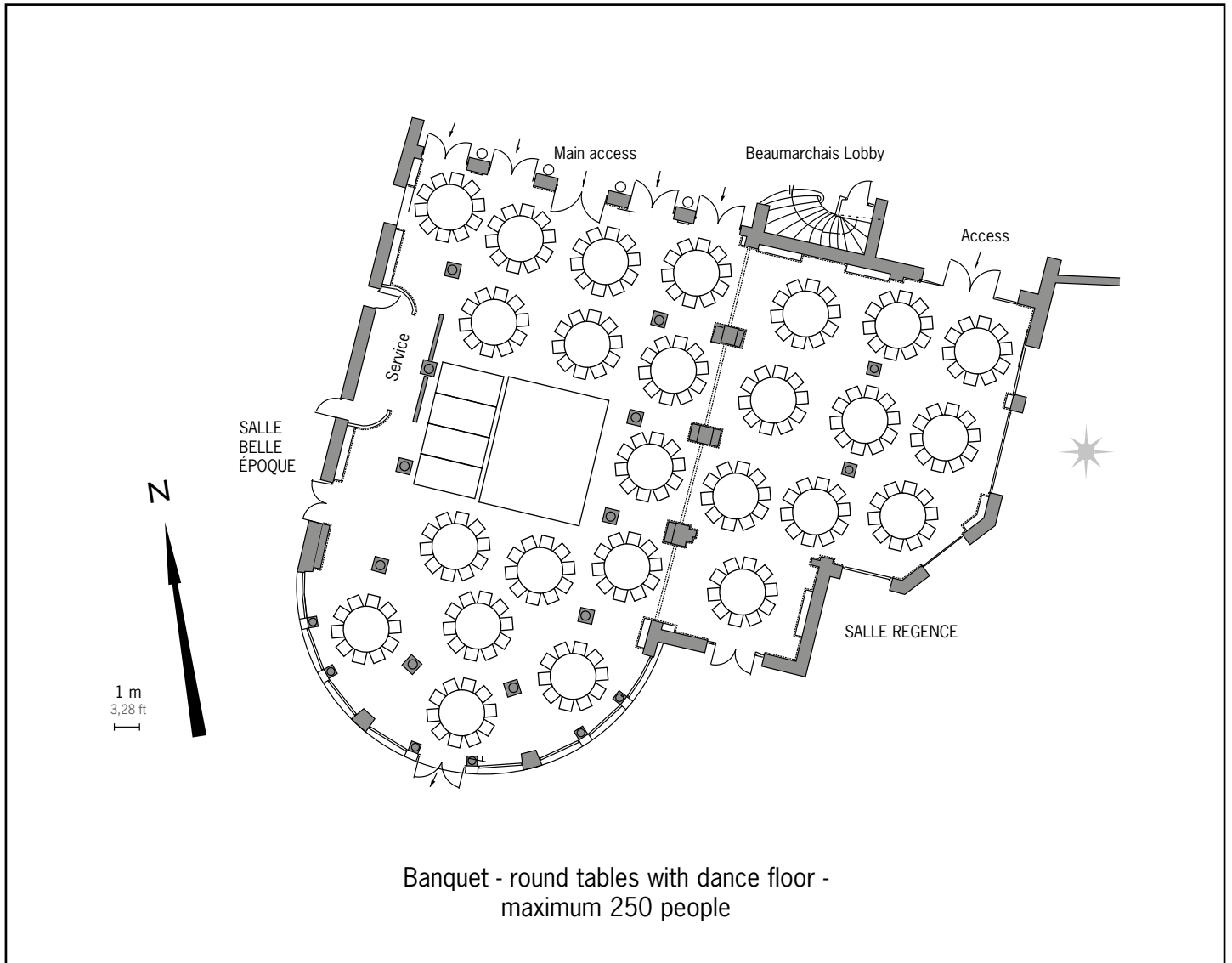

For technical information, please refer to general floorplan (without set-up)